

April 8, 2024

All Bidders

Re: **Addendum No. 1**

Gettysburg Regional Airport
 Construct South aircraft Parking apron – Phase VI
 TranSystems Project No: P707220067

Dear Bidders:

The contents of this Addendum alter and amend the original drawings and specifications and take precedence over the related items herein. This letter addendum (3 pages) and accompanying attachments (26 pages) are being sent via PennBid only.

CLARIFICATIONS / ADDENDUM CHANGES

- C1. The Pre-Bid Meeting Minutes from April 3, 2024 are provided with this Addendum.
- C2. Duplicate DBE Forms can be removed from the project manual.
- C3. Bidding date was updated in PennBid prior to the pre-bid meeting.

PROJECT MANUAL

M1. Please replace the following page(s) in the Project Manual with the included sheet(s). Page number(s) on the bottom of the page(s) correspond with those in the Project Manual. All addendum additions on these page(s) are shown in bold and italic text, and text deletions are shown using strike-through text.

Page Number	Description	Direction
NTB-1	Revised Contract hold to time match 120 day limit	Replace Page
BF-3	Removal of C-100	Replace Page
BFA-1	Project corrected to Phase VI	Replace Page
A-6	Including P-151 and removal of C-100	Replace Page
A-7	Revised Plan Names to Match Plan Set	Replace Page
A-10	Work Areas Updated	Replace Page
HIA DBE-1	Duplicate forms removed	Remove Page
Contractor Status Report of Forms A & B	Duplicate forms removed	Remove Page
DBE Forms A, B, and C	Duplicate forms removed	Remove Pages
Div 10 – Index Page-1	Title Sheet Revisions	Replace Page
Div 10 – C-100-1	Removed C-100 Specification	Remove Pages

PLAN SHEET CHANGES

P1. Please replace the following plan sheets with the included sheet(s). All addendum additions on these page(s) are shown in bold and italic text, and text deletions are shown using strike-through text.

Sheet #	Description	Direction
AP-01	Revised Quantity Sheet	Replace Sheet
AP-04	Revised Calendar days and Work Areas	Replace Sheet
AP-12	Revised Seeding Legend and Notes	Replace Sheet
AP-16	Revised Culvert 1 Channel Elevation	Replace Sheet
AP-17	Revised General Notes	Replace Sheet
AP-22	Revised Underdrain Detail	Replace Sheet

LIST OF ATTACHMENTS

1. Pre-Bid Meeting Minutes and Sign-In Sheet (12 Pages)
2. Notice for Invitation to Bid, Page 1 (1 Page)
3. Bid Form, Page 3 (1 Page)
4. Bid Bond, Page 1 (1 Page)
5. Agreement, Pages 6, 7, 10 (3 Pages)
6. Division 10 Index Page (1 Page)
7. Division 10 Specification C-100 (1 Page)
8. Plan Sheets (AP-01, AP-04, AP-12, AP-16, AP-17, and AP-22) (6 Pages)

- END OF ADDENDUM -

The inclusion of this Addendum shall be noted on Page 3-2 of the Proposal and the signature of the Bidder shall indicate full acceptance of the provisions herein.

All other provisions of these Specifications, Drawings, and Contract Documents shall remain unchanged and in full effect.

This Addendum shall be signed and attached to the Form of Proposal for the referenced contract. This Addendum shall also be attached to and become part of the Specifications for this Contract.

Sincerely,



Gregory L. Schrock, PE, CPESC
Aviation and Civil Engineering Services

ADDENDUM NO. 1 (include a signed copy of this page with the Bid Proposal)

Contractor

Signed

Dated

GLS/tjn

Enclosures

cc: Tyler Nesbella, TranSystems
Timothy P. DeWire, FAA
Anna Ellis, PennDOT BOA
John Logan, PennDOT BOA
Louis Pirozzi, SARAA

Airport: Gettysburg Regional Airport (W05)
Project: Construct South Aircraft Parking Apron, Phase VI
Subject: Pre-Bid Meeting

Project Nos. P707220067
Meeting Date: April 3, 2024
Meeting Time: 10:00 am

Meeting Location: Gettysburg Regional Airport Conference Room
 1130 Chambersburg Road, Gettysburg, PA 17325

Attendance: See Attached Sign-In Sheet.

A. OPENING AND INTRODUCTIONS

B. BIDDING REQUIREMENTS

1. BIDS ACCEPTED UNTIL
2. DATE, TIME AND LOCATION OF BID OPENING
3. BIDS SECURITY
4. BIDS MAY BE HELD
5. PLANS AVAILABILITY
6. BID QUESTIONS
7. INSTRUCTIONS TO BIDDERS

C. CONTRACT DOCUMENTS

1. BID FORMS
2. BID BOND/BID SECURITY
3. CONTRACT FORMS
4. PERFORMANCE BOND
5. LABOR AND MATERIAL PAYMENT BOND
6. STATUTES AND REGULATIONS REQUIRED BY SARAA
7. SARAA GENERAL AND SUPPLEMENTARY CONDITIONS
8. FAA GENERAL PROVISIONS
9. DIVISION 1 – GENERAL REQUIREMENTS
10. TECHNICAL SPECIFICATIONS

D. GENERAL PROJECT SCOPE

1. BASE BID
2. DEDUCT ALTERNATE

E. ANTICIPATED PROJECT SCHEDULE

1. CONTRACT TIME
2. ANTICIPATED SCHEDULE

F. PROJECT FUNDING/ESTIMATE

1. ANTICIPATED FUNDING
2. ENGINEER OPINION OF PROBABLE COST RANGE

G. OPERATIONAL SAFETY/PHASING

1. CONSTRUCTION SAFETY AND PHASING PLAN (CSPP) - ACCEPT
2. SAFETY PLAN COMPLIANCE DOCUMENT (SPCD)
3. GENERAL OPERATIONAL SAFETY/PHASING REQUIREMENTS

H. OPEN DISCUSSION AND QUESTIONS

I. SITE VISIT

Airport: Gettysburg Regional Airport (W05)
Project: Construct South Aircraft Parking Apron, Phase IV
Subject: Pre-Bid Meeting

Project Nos. P707220067
Meeting Date: April 3, 2024
Meeting Time: 10:00 am

Discussion	Action/Response
------------	-----------------

A. Opening and Introductions

TranSystems advised that this meeting was being held and its agenda had been prepared to assist the Owner in compliance with the requirements of FAA AC 150/5370-12B, "Quality Management for Federally Funded Airport Construction Projects", as well as, Chapter 6 of the "FAA Eastern Region Airports Division Sponsor Guide".

1. See attached Meeting Attendance Record for a list of attendees.

B. Bidding Requirements

TranSystems reviewed the bidding requirements for this project as follows:

1. Bids Accepted Until

Friday, April 26, 2024; 2:00 PM

2. Date, Time and Location of Bid Opening

Friday, April 26, 2024; 2:00 PM

Via PennBid portal

3. Bids Security

A Bid Bond or Certified Check in the amount of 10% of the Contractor's Base Bid price must accompany the bid proposal.

4. Bids May Be Held

120 Calendar Days

5. Plans Availability

Plan Deposit: \$0.00 electronic format via PennBid.

TranSystems advised that Contract Documents are available in electronic PDF format only.

Airport: Gettysburg Regional Airport (W05)
Project: Construct South Aircraft Parking Apron, Phase IV
Subject: Pre-Bid Meeting

Project Nos. P707220067
Meeting Date: April 3, 2024
Meeting Time: 10:00 am

6. Bid Questions

Any questions or interpretations of the plans, specifications or documents must be submitted, in writing, no later than close of business on **April 17, 2024** on the PennBid forum.

7. Instructions to Bidders

- a. It is the intent of the OWNER to award a Contract to the lowest responsible Bidder providing the Bid has been submitted in accordance with the requirements of the Bidding Documents and does not exceed the funds available. The OWNER shall have the right to waive informalities or irregularities in a Bid received and to accept the Bid which, in the OWNER's judgment, is in the OWNER's best interest.
- b. The OWNER shall have the right to accept Alternates in any order or combination, unless otherwise specifically provided in the Bidding Documents, and to determine the low Bidder on the basis of the sum of the Base Bid and Alternates accepted. ENGINEER advised that the contract would be awarded to a single contractor, and that the awarded contract would be for just the Base Bid or the Base Bid minus the DEDUCT alternate.

C. Contract Documents

1. Bid Forms

- a. The Proposal form must be completed in its entirety.
- b. All Addendums must be noted on the proposal in paragraph (f)
- c. All SubContractors must be listed on the Proposal in paragraph (g)
- d. Bid Bond – completed and signed
- e. Consent of Surety – completed and signed
- f. Resolution of Board of Directors – completed and signed
- g. Non-Collusion Affidavit of Prime Bidder – completed and signed
- h. HIA DBE-1 form – May be submitted with bid. Required to be submitted by low bidder and 2nd low bidder with 24 hours of bid opening.
- i. Equal Employment Opportunity Report Statement – completed and signed
- j. Bidders Experience – completed
- k. References – completed

Airport: Gettysburg Regional Airport (W05)
Project: Construct South Aircraft Parking Apron, Phase IV
Subject: Pre-Bid Meeting

Project Nos. P707220067
Meeting Date: April 3, 2024
Meeting Time: 10:00 am

- l. Certificate of Non-Segregated Facilities – completed and signed
- m. Federal Language Contract Certificate
- n. Certificate of Buy American Compliance – completed and signed
- o. Certification of Bidder Regarding Debarment
- p. Certification Regarding Lobbying
- q. Certification of Bidder Regarding Tax Delinquency and Felony Convictions – completed
- r. Trade Restriction Certification
- s. Bid Submission Checklist – completed and initialed

2. Bid Bond/Bid Security

- a. Carefully read and comply with the requirements set forth in the General Instructions for Bid Bonds.
- b. Bid Bond shall be in the amount of ten (10%) percent of the Base Bid.

3. Contract Forms

- a. The successful Bidder will execute the Agreement contained in this section with the Owner and return it within 20 calendar days of Notice of Intent to Award.
- b. The PennDOT Bureau of Aviation will check the Prime and all Subcontractors for debarment from work in Pennsylvania, and the Federal Aviation Administration will check the Federal SAMS list.
- c. Waiver of Lien Form – completed and signed

4. Performance Bond

- a. The successful Bidder will execute the Bond contained in this section with the Owner for an amount equal to 100% of the amount awarded for Performance and Payment.
- b. This Bond shall remain in effect for a period of two (2) years after the date of final payment.

Airport: Gettysburg Regional Airport (W05)
Project: Construct South Aircraft Parking Apron, Phase IV
Subject: Pre-Bid Meeting

Project Nos. P707220067
Meeting Date: April 3, 2024
Meeting Time: 10:00 am

5. Labor and Material Payment Bond

- a. The successful Bidder will execute the Bond contained in this section with the Owner for an amount equal to 100% of the amount awarded.
- b. This Bond shall remain in effect for a period of two (2) year after the date of final payment.

6. Statutes and Regulations Required by SARAA

- a. This section of the Project Manual contains information regarding acts/laws that are required by the federal/state/locality where the project is located.

7. SARAA General and Supplementary Conditions

- a. General Conditions – This section contains SARAA General Conditions
 - Article 2 – Preliminary Matters
 - Article 5 – Insurance

Workers Compensation and Employer’s Liability Insurance:

- 1. Worker’s Compensation – Pennsylvania Statutory Coverage.
- 2. Minimum amounts of employer’s liability insurance shall be as follows:
 - \$500,000 – Each Accident
 - \$1,000,000 – Policy Limit
 - \$500,000 – Disease – Each Employee

General Liability Insurance:

- \$2,000,000 – Aggregate
- \$2,000,000 – Each Occurrence

Automobile Liability Insurance for all automobiles, trucks and similar equipment owned, leased rented:

- Minimum amounts for Automobile Liability Insurance shall be as follows:
- \$1,000,000 – Bodily Injury (Per Person)
 - \$2,000,000 – Bodily Injury (Per Accident)
 - \$2,000,000 – Property Damage

Environmental Pollution Liability Insurance:

- \$1,000,000 – Policy Limit

The Contractor shall, at its own expense, procure and maintain Environmental Protection Liability coverage in the amount of \$1,000,000 Policy Limit, insuring

Airport: Gettysburg Regional Airport (W05)
Project: Construct South Aircraft Parking Apron, Phase IV
Subject: Pre-Bid Meeting

Project Nos. P707220067
Meeting Date: April 3, 2024
Meeting Time: 10:00 am

its operation, itself, and SARAA against any leaks, spills or environmental cleanups for the benefit of SARAA and itself.

- Article 6 - Contractor Responsibilities
 - Article 10 – Changes in the Work
 - Article 12 – Change of the Contract Time
 - Article 14 – Payments to Contractor and Completion
- b. Supplementary Conditions- This section contains the Supplementary Conditions
- DBE Goal – thirteen and 99 hundredths percent (13.99%) of the original contract amount.
 - Contractor will be required to submit Form HIA DBE-1 within 24 hours of bid opening.
 - Monthly Status Report, Forms A, B, and C will need to be submitted with each application for payment.
 - Davis Bacon Wage Rates apply to the work on this Project.

8. FAA General Provisions

a. General Provisions

This section of the Project Manual contains the FAA Standard General Provisions required for all contracts on airports involving Airport Improvement Program (AIP) Funding.

9. Division 1 – General Requirements

a. Special Provisions

To tailor the Project for local conditions and requirements, this section also contains Special Provisions.

b. Items for consideration

- Contractor shall submit Catalog Cuts on all materials to Engineer.
- Items that increase or decrease by less than 25% can be approved by a change order with proper justification and approval before work begins.
- Time extensions must be justified and shutdowns for weather will be allowed with proper Stop Work Order/Start Work Order.
- Daily meeting will be held to discuss the planned work and any issues. The attendees of these daily meeting will be at a minimum the Construction Manager and the Contractor’s superintendents.
- Bi-weekly Job conferences will be held to discuss the progress of work and any issues that may need to be addressed.
- Pay quantities shall be based on measured field quantities.

Airport: Gettysburg Regional Airport (W05)
Project: Construct South Aircraft Parking Apron, Phase IV
Subject: Pre-Bid Meeting

Project Nos. P707220067
Meeting Date: April 3, 2024
Meeting Time: 10:00 am

- All Shop Drawings shall be submitted through Newforma for review.
- Pay request shall be submitted to Engineer monthly on a form provided by the Engineer. Included with each pay app will be all DBE forms required per SARAA Supplementary Conditions and certified payrolls. Contractor's and Sub-Contractor's first and last payrolls must be notarized and original hard copy provided.
 - Contractor is responsible for construction layout. The Engineer shall establish necessary horizontal and vertical control.
 - All surveying for the project shall be provided, signed, and sealed by a licensed Professional Land Surveyor of the State of Pennsylvania.
- Project Bulletin Board – Post immediately including wage rates, wage rate posters, and EEO policies. Information may be maintained in a project binder. Details will be determined at Pre-Construction meeting.
- Contractor shall maintain As-Built Drawings that shall be provided to the Engineer at completion of the project. Retainage will not be released until the as-built drawings are received.

10. Technical Specifications

- a. Aviation Technical Specifications have been prepared in accordance with FAA Advisory Circular (AC) 150/5370-10H, Standards for Specifying Construction of Airports.
- b. TranSystems advised the Contractor to review each item carefully in regards to what is incidental, what is being measured and how items are being paid for as required.
- c. Availability of Advisory Circulars (AC's). Current copies of FAA ACs applicable to a project are available to prospective bidders, on the FAA Website at www.faa.gov.

Airport: Gettysburg Regional Airport (W05)
Project: Construct South Aircraft Parking Apron, Phase IV
Subject: Pre-Bid Meeting

Project Nos. P707220067
Meeting Date: April 3, 2024
Meeting Time: 10:00 am

D. General Project Scope

TranSystems provided an overview of the general project scope as follows:

1. Base Bid

The Gettysburg Regional Airport Construct South Apron Phase VI project is a site improvements project. The project consists of the construction and grading of the taxiway extending from the southeastern paved taxiway to the runway in the southwest corner of the property. The contractor will also extend the existing construction access road to the southern end of the site away from the newly paved apron and taxiway. Excess material excavated from this area will be exported off the project site. Stormwater facilities including a stormwater retention basin and stormwater conveyance system to be constructed with the project. This conveyance system includes inlets, drainage pipe, rip-rap aprons, and channel construction. Erosion and sedimentation control facilities will be installed for the project to control sediment and the entire disturbed area will be seed and mulched to prepare for future phases of construction. Any wetlands near the project area will be fenced off and not directly impacted by construction other than what is specifically shown on the plans.

- **Township approvals are in place.**
- **Joint & NPDES permit in place.**
- **Co-permittee will be required.**

2. DEDUCT Alternate

This portion of the project includes the reduction of quantities from the base bid.

E. Anticipated Project Schedule

1. Contract Time

Mobilization:	15 Calendar Days
Work Area One (1):	40 44 Calendar Days
Work Area Two (2):	20 25 Calendar Days
Work Area Three (3):	5 10 Calendar Days
Work Area Four (4):	5 Calendar Days
Substantial Completion:	5 1 Calendar Day
Punchlist/Final Completion:	30 Calendar Days
Total Contract Time:	120 Calendar Days

- WA1 – Work outside of the ROFA
- WA2 -Inside ROFA pull back method is acceptable
- WA3 -Inside RSA, Runway must be shutdown
- ~~WA4 – Work outside ROFA and within pavement boundaries~~

Once the NTP has been issued, the Contractor will have 14 calendar days to Mobilize/Start construction. If the Contractor did not start within the 14 days, the Contract Time would automatically begin on day 15.

All required work is to be completed, grades restored, excess material removed and as built documentation received by the CM; within the 120 calendar days. If any days go beyond this, those days shall be subject liquidated damages.

Following the Substantial Completion inspection a punchlist would be generated and that work is to be completed within the 30 calendar days allotted.

Airport: Gettysburg Regional Airport (W05)
Project: Construct South Aircraft Parking Apron, Phase IV
Subject: Pre-Bid Meeting

Project Nos. P707220067
Meeting Date: April 3, 2024
Meeting Time: 10:00 am

2. Anticipated Schedule

04/17/2024	5:00 PM Last Day for Questions
04/18/2024	Final Addendum Issued
04/26/2024	Bid Opening via PennBid
05/01/2024	Submit request for FAA/BOA concurrence
05/08/2024	Submit Grant Application to FAA
Summer 2024	Construction Grant Executed / Notice of Award
Summer 2024	Pre-Construction Conference
Summer 2024	Issue Construction NTP
Summer 2024	Start Construction
Fall 2024	Substantial Completion
Fall 2024	Substantial Completion Inspection
Fall 2024	Final acceptance
Winter 2024	Grant Close-out

F. Project Funding/Estimate

1. Anticipated Funding

Federal Aviation Administration (FAA):	90%
PENNDOT Bureau of Aviation (BOA):	5%
Susquehanna Area Regional Airport Authority (SARAA):	5%

2. Engineer Opinion of Probable Cost Range

Base Bid: \$700,000 - \$1,000,000

G. Operational Safety/Phasing

1. Construction Safety and Phasing Plan (CSPP) - accept

- a. The operational safety requirements included will be in accordance with FAA requirements (AC 150/5370-2G) and covered in Construction Safety and Phasing Plan contained in Attachment B have been submitted to the FAA for approval.

2. Safety Plan Compliance Document (SPCD)

- a. Pursuant to the requirements set forth in Federal Aviation Administration (FAA)

Airport: Gettysburg Regional Airport (W05)
Project: Construct South Aircraft Parking Apron, Phase IV
Subject: Pre-Bid Meeting

Project Nos. P707220067
Meeting Date: April 3, 2024
Meeting Time: 10:00 am

Advisory Circular 150/5370-2G, an SPCD for this project shall be submitted to the Owner, Engineer, FAA and PENNDOT Bureau of Aviation (BOA) for review and approval. This should be submitted 14 days prior to the preconstruction conference. The notice-to-proceed cannot be issued without approval of this document.

3. General Operational Safety/Phasing Requirements

- a. Review Airport Operational Safety and Phasing Plans.
- b. Staging areas – identified on plans. This area was subject to a 25' height restriction.
- c. Haul routes – identified on plans.
- d. The Contractor will be required to have an adequate number of radios on the frequency of 122.900 MHz to monitor air traffic when working on this project within the Aircraft Operational Area (AOA). The AOA consists of all runway, taxiway, and apron pavement areas and associated safety areas. The OWNER reserves the right to revoke access to contractor personnel for any violation of airport safety.
- e. ALL vehicles and equipment shall be properly marked with flags and/or flashing amber lights during daytime construction and flashing amber lights for night construction and during times of limited visibility.

H. Open Discussion and Questions

The questions and their responses will be included in Addendum No. One (1).

- Questions: **Date was updated in PennBid.**

I. Site Visit

1. Site visit should be coordinated through SARAA; Mr. Louis Pirozzi, Project Manager, 717-948-3900, Louis.Pirozzi@saraa.org

Airport: Gettysburg Regional Airport (W05)
Project: Construct South Aircraft Parking Apron, Phase IV
Subject: Pre-Bid Meeting

Project Nos. P707220067
Meeting Date: April 3, 2024
Meeting Time: 10:00 am

END OF MINUTES-

These minutes are the writer's interpretation of the meeting. Should you have any comments regarding any of the items please contact me within ten (10) calendar days of the date of these minutes. If no comments are received by this time, it will be considered that all attendees are in agreement.

Sincerely,



Gregory L. Schrock, PE
Aviation and Civil Engineering Services

GLP/arr

XC:
All Attendees Except
All Committee Members



Meeting Attendance Record

Airport: Gettysburg Regional Airport (W05)
Project: Construct South Aircraft Parking Apron, Phase VI
Subject: Pre-Bid Meeting

Project Nos. P707220067
Meeting Date: April 3, 2024
Meeting Time: 10:00 am

Name	Representing	Office/Mobile Phone	Email	Present
Louis Pirozzi	SARAA – Deputy Director of Engineering & Planning	717-948-3900 x4606	Louis.Pirozzi@saraa.org	<input type="checkbox"/> Virtual Attendance
Gregory L. Schrock	TranSystems Corp	814-419-7883 814-244-3009	glschrock@transystems.com	<input type="checkbox"/> Virtual Attendance
Tyler Nesbella	Transystems Corp	814-419-7871	tnesbella@transystems.com	<input type="checkbox"/> Virtual Attendance
Rodney King	SARAA –Engineering & Planning	717-948-3900	Rodney.king@saraa.org	<input type="checkbox"/> Virtual Attendance
Brandi L. Barna	Conewago Enterprises, Inc.	717-632-7722	bbarna@conewago.com	<input checked="" type="checkbox"/> Virtual Attendance
Greg Gress	Howell Surveying	610-918-9002	ggress@knowhowell.com	<input checked="" type="checkbox"/> Virtual Attendance
Jeannette Gumby	SARAA – Engineering Contracts & Grant Administrator	717-948-3900 x4605	jeannetteg@saraa.org	<input checked="" type="checkbox"/> Virtual Attendance
Ron Morris	ADCI Corporation	717-979-5465	rmorris@adci-corp.com	<input checked="" type="checkbox"/> Virtual Attendance
Arielle Lewis	SARAA – Engineering Contracts & Grant Administrator	717-948-3900 x4611	Arielle.lewis@saraa.org	<input checked="" type="checkbox"/> Virtual Attendance

Susquehanna Area Regional Airport Authority
GETTYSBURG REGIONAL AIRPORT
CONSTRUCT SOUTH AIRCRAFT PARKING APRON – PHASE VI
Contract No. 2009-003

NOTICE FOR INVITATION TO BID

Susquehanna Area Regional Airport Authority (SARAA) shall receive bids via PennBid for bidding of CONSTRUCT SOUTH AIRCRAFT PARKING APRON – PHASE VI at Gettysburg Regional Airport (W05) **until 2:00 PM, April 26, 2024** at which time they shall be opened online and publicly posted via PennBid. The Authority will consider bids at its May 29, 2024, board meeting which is held in the David McIntosh Board Room located on the 3rd floor of HIA's (Harrisburg International Airport) Terminal Building beginning at 8 a.m.

All documents and solicitation details are available at no cost on PennBid – www.PennBid.net.

Bids will be considered if received prior to the scheduled time that bids are to be received. The Owner assumes no responsibility for bids not received.

Bid packages will be received via PennBid and identified for the following contract:

Gettysburg Regional Airport
Construct South Aircraft Parking Apron – Phase VI
Project No. 2009-003

The work site is located at Gettysburg Regional Airport, in Gettysburg, Pennsylvania. Contractor shall complete all work as specified or indicated in the Contract Documents. The construction scope of work includes, but is not limited to:

The Gettysburg Regional Airport Construct South Apron Phase VI project is a site improvements project. The project consists of the construction and grading of the taxiway extending from the southeastern paved taxiway to the runway in the southwest corner of the property. The contractor will also extend the existing construction access road to the southern end of the site away from the newly paved apron and taxiway. Excess material excavated from this area will be exported off the project site. Stormwater facilities including a stormwater retention basin and stormwater conveyance system to be constructed with the project. This conveyance system includes inlets, drainage pipe, rip-rap aprons, and channel construction. Erosion and sedimentation control facilities will be installed for the project to control sediment and the entire disturbed area will be seed and mulched to prepare for future phases of construction. Any wetlands near the project area will be fenced off and not directly impacted by construction other than what is specifically shown on the plans.

Complete sets of Contract Documents and Bid Forms may be obtained beginning **March 24, 2024** via PennBid. Only bidders receiving full sets of documents will be on record to receive Addenda.

All bids must be made on the official Bid Form or an exact copy by re-production thereof. Owner reserves the right to reject any and all bids, to waive any and all informalities and the right to reject all non-conforming, non-responsive or conditional bids, in the Owners sole discretion.

No Bidder may withdraw his bid within ~~60~~ **120** days after the actual date of the opening thereof unless award is delayed due to the required approval of another government agency, the sale of bonds, or the award of grant or grants; in which case, bids shall be irrevocable for one hundred twenty (120) calendar days in compliance with Act 317 of 1978 approved November 26, 1978. Each bid must be accompanied by a Bid Security in the amount of ten percent (10%) of the base bid in accordance with the Instructions to Bidders.

The successful Bidder will be required to furnish a Performance Surety Bond and a Payment Bond each in the full amount of the Contract Price.

Susquehanna Area Regional Airport Authority
GETTYSBURG REGIONAL AIRPORT
CONSTRUCT SOUTH AIRCRAFT PARKING APRON – PHASE VI
Contract No. 2009-003

(h) BIDDER will complete all the Work for the Total Amount Shown in the Cost Proposal:

SUMMARY OF QUANTITIES					
BASE BID					
ITEM	DESCRIPTION	UNIT	QTY.	UNIT PRICE	ITEM COST
C-100-14.1	CONTRACTOR QUALITY CONTROL PROGRAM _____ UNIT PRICE (Written in words)	LS	1		
C-102-5.1	INLET SEDIMENT FILTER _____ UNIT PRICE (Written in words)	EA	6		
C-102-5.2	ROCK CONSTRUCTION ENTRANCE _____ UNIT PRICE (Written in words)	EA	1		
C-102-5.3	FILTER SOCK, 12" _____ UNIT PRICE (Written in words)	LF	900		
C-102-5.4	ROCK, CLASS R-3 RIP RAP APRON _____ UNIT PRICE (Written in words)	CY	10		
C-102-5.5	ROCK, CLASS R-4 RIP RAP APRON _____ UNIT PRICE (Written in words)	CY	80		
C-102-5.6	EROSION CONTROL MULCH BLANKET _____ UNIT PRICE (Written in words)	SY	2,000		
C-102-5.7	FILTER FABRIC (UNDERDRAIN WRAPPING) _____ UNIT PRICE (Written in words)	SY	2,750		
C-102-5.8	GEOTEXTILE LINER (RIPRAP APRONS) _____ UNIT PRICE (Written in words)	SY	140		

Susquehanna Area Regional Airport Authority
GETTYSBURG REGIONAL AIRPORT
CONSTRUCT SOUTH AIRCRAFT PARKING APRON – PHASE VI
Contract No. 2009-003

BID BOND

KNOW ALL MEN BY THESE PRESENTS:

THAT _____

of _____ as Principal,

and _____ a corporation organized and

existing under the laws of the State of _____ and authorized to do business in the Commonwealth of Pennsylvania, as Surety, are held and firmly bound unto the Susquehanna Area Regional Airport Authority, Dauphin County, Pennsylvania, as Obligee, in the full and just sum of

_____ Dollars (\$ _____), lawful money of the United States of America, for the payment of which sum, well and truly to be made, we bind ourselves, our heirs, executors, administrators, successors and assigns, jointly and severally, firmly by these presents.

WHEREAS, the said Principal is herewith submitting its Bid Proposal for a project to Construct South Aircraft Parking Apron – Phase ~~IV~~ **VI**, Project No. 2009-003, at Gettysburg Regional Airport in Gettysburg, Pennsylvania.

THE CONDITION OF THIS OBLIGATION is such that if the aforesaid Principal shall be given Notice of Intent to be awarded the Contract, the said Principal will, within the time required, give good and sufficient Bonds to secure the performance of the Terms and Conditions of the Contract and enter into an Agreement, then this obligation to be void; otherwise, the Principal and Surety will pay unto the Obligee the full amount of the Bid Security.

Signed, Sealed and Delivered this _____ day of _____, 20____.

Attest

PRINCIPAL

_____/s/
Secretary

By: _____/s/
President/Owner

(SEAL)

SURETY

_____/s/
Witness

By: _____/s/
Attorney-in-Fact

(SEAL)

NOTES:

Attach an appropriate Power of Attorney, dated as of the same date as the bond, evidencing the authority of the Attorney-in-Fact to act on behalf of the corporation.

If the Contractor is a Partnership, all partners shall execute the bond.

Surety companies executing bonds must appear on the U.S. Department of the Treasury most current Bond List (Circular 570 as amended). Bond amounts are subject to the underwriting limitation listed in the most recent Circular 570.

Susquehanna Area Regional Airport Authority
GETTYSBURG REGIONAL AIRPORT
CONSTRUCT SOUTH AIRCRAFT PARKING APRON – PHASE VI
Contract No. 2009-003

CONTRACT FORMS

- Agreement
- Lobbying Certification Form
- Performance Bond
- Payment Bond
- Waiver of Lien
- FAA Drug Free Workplace

STATUTES AND REGULATIONS REQUIRED FOR SARAA CONTRACTS

GENERAL CONDITIONS

SUPPLEMENTARY CONDITIONS

- Disadvantaged Business Enterprise Participation Plan
Form A, B, C, A & B, and Form HIA DBE -1
- Davis-Bacon Wage Rates

FAA GENERAL PROVISIONS

DIVISION 1 – GENERAL REQUIREMENTS

SUMMARY OF WORK

MILESTONES

PROJECT CLOSEOUT

- Consent of Surety to Final Payment
- Contractor's Affidavit
- Contractor's Release

TECHNICAL SPECIFICATIONS

C-100	Contractor Quality Control Program (CQCP)
C-102	Temporary Air and Water Pollution, Soil Erosion, and Siltation Control
C-105	Mobilization/Contractor's Plant
M-001	Maintenance and Protection of Air and Vehicle Traffic During Construction
<i>P-151</i>	<i>Clearing and Grubbing</i>
P-152	Excavation, Subgrade, and Embankment
P-154	Subbase Course
D-701	Pipe for Storm Drains and Culverts
D-705	Pipe Underdrains for Airports
D-751	Manholes, Catch Basins, Inlets and Inspection Holes
D-752	Concrete Culverts, Headwalls, and Miscellaneous Drainage Structures
T-901	Seeding
T-905	Topsoil
T-908	Mulching

Susquehanna Area Regional Airport Authority
GETTYSBURG REGIONAL AIRPORT
CONSTRUCT SOUTH AIRCRAFT PARKING APRON – PHASE VI
Contract No. 2009-003

CONTRACT DRAWINGS

AP-01	Title Sheet and Drawing Index
AP-02	General Notes
AP-03	Site Plan
AP-04	Airport Operational Safety and Phasing Plan
AP-05	Operational Safety and Phasing Plan Details
AP-06	Geometry Plan
AP-07	Geometry Charts
AP-08	Grading & Drainage Plan
AP-09	Overall Limit of Disturbance
AP-10	Erosion and Sedimentation Control Details Plan – Sheet 1 of 2
AP-11	Erosion and Sedimentation Control Details Plan – Sheet 2 of 2
AP-12	Seeding Plan
AP-13	Boring Plan
AP-14	Boring Logs
AP-15	Test Pit Information
AP-16	Pipe Profiles
AP-17	E & S Details – Sheet 1 of 5
AP-18	E & S Details – Sheet 2 of 5
AP-19	E & S Details – Sheet 3 of 5
AP-20	E & S Details – Sheet 4 of 5
AP-21	E & S Details – Sheet 5 of 5
AP-22	Drainage Details
AP-23	Stormwater Management Details – Sheet 1 of 2
AP-24	Stormwater Management Details – Sheet 2 of 2
AP-25	Taxiway Profile

There are no Contract Documents other than those listed in this Article 8. The Contract Documents may only be altered, amended or repealed by a Modification (as defined in Article 1 of the General Conditions).

ARTICLE 9 - MISCELLANEOUS

- 9.1 No assignment by a party hereto of any rights under, or interest in, the Contract Documents will be binding on another party hereto without the prior written consent of the party sought to be bound; and specifically but without limitation, moneys that may become due and moneys that are due may not be assigned without such consent (except to the extent that the effect of this restriction may be limited by law), and unless specifically stated to the contrary in any written consent to an assignment, no assignment will release or discharge the assignor from any duty or responsibility under the Contract Documents.
- 9.2 **SARAA** and **CONTRACTOR** each binds himself, his partner, successors, assigns and legal representatives to the other party hereto, his partners, successors, assigns and legal representatives in respect to all covenants, agreements and obligations contained in the Contract Documents.
- 9.3 Partial Invalidity. If any term, part, provision, section, subdivision or paragraph of these Contract Documents shall be held unconstitutional, invalid or ineffective, in whole or in part, such determination shall not be deemed to invalidate the remaining terms, parts, provisions, sections, subdivisions and paragraphs thereof.
- 9.4 The Contractor shall have full responsibility for safety for his contract work and shall indemnify, defend and hold harmless the Owner, its directors, officers, agents, employees and sub-consultants (regardless of tier) from and

**Susquehanna Area Regional Airport Authority
 GETTYSBURG REGIONAL AIRPORT
 CONSTRUCT SOUTH AIRCRAFT PARKING APRON – PHASE VI
 Contract No. 2009-003**

**Attachment A to Article 3
 CONSTRUCTION MILESTONES**

	Calendar days after NTP		Duration in Calendar days
	Start	Substantial Completion	
Mobilization	1	15	15
Work Area One	15	55 59	40 44
Work Area Two	55 * 59	75 * 84	20 * 25
Work Area Three	75 84	80 89	5
Work Area Four	80	85	5
Substantial Completion	85 89	90-90	1
Final Inspection	90	120	30

*DEDUCT Alternate will remove 5 calendar days from Work Area Two reducing overall contract time to 115 days.

The above schedule provides a sequence of work that is necessary to complete the project. This contractor is required to furnish sufficient personnel in order to accomplish the durations and sequence identified in this schedule. The contractor is required to complete each work item within the required duration. All durations include setup and demobilization. For the interest of this schedule; Substantial Completion is that date that all required work is complete, grades have been restored as designed, excess material is removed from site; and as-built documentation is received by the CM. Final completion will not be satisfied until all punchlist items are complete and approved by the Designer of Record.

**Final completion of all work: 120 days after Notice to Proceed (NTP)
 (Provided all Bid Items are awarded.)**

DIVISION 10 – DETAILED SPECIFICATION

INDEX

<u>ITEM</u>	<u>DESCRIPTION</u>	<u>PAGES</u>
Item C-100	Contractor Quality Control Program (CQCP)	1
Item C-102	Temporary Air and Water Pollution, Soil Erosion, and Siltation Control	1
Item C-105	Mobilization/Contractor's Plant	1
Item M-001	Maintenance and Protection of Air and Vehicle Traffic During Construction	1
Item P-151	Clearing and Grubbing	1
Item P-152	Excavation, Subgrade, and Embankment	1
Item P-154	Subbase Course	1
Item D-701	Pipe for Storm Drains and Culverts	1
Item D-705	Pipe Underdrains for Airports	1
Item D-751	Manholes, Catch Basins, Inlets and Inspection Holes	1
Item D-752	Concrete Culverts, Headwalls, and Miscellaneous Drainage Structures	1
Item T-901	Seeding	1
Item T-905	Topsoil	1
Item T-908	Mulching	1

Modifications to Standard FAA Technical Specifications. The technical specifications and general provisions are based on FAA AC 150/5370-10H, "FAA Standards for Specifying Construction of Airports." Some Commonwealth of Pennsylvania, Department of Transportation Standard Specifications, ~~Publication 408/2013~~ **most current publication**, have been used where appropriate. Other specifications were developed by the Engineer, if not otherwise available. All FAA specifications are denoted with the AC reference and date of revision at the beginning of each specification section for ease of future reference to the specification version utilized for this project. The title of any non-FAA specification is shaded. Modifications by way of additions to the FAA standard are denoted with shaded text. If required by the FAA, Engineers optional text is denoted with **BOLD** text. Deletions to the FAA standards are reflected by the use of strike through.

ITEM C-100 CONTRACTOR QUALITY CONTROL PROGRAM (CQCP)

GETTYSBURG REGIONAL AIRPORT (W05) CONSTRUCT SOUTH AIRCRAFT PARKING APRON, PHASE VI

CUMBERLAND TOWNSHIP, ADAMS COUNTY, PA

SARAA PROJECT NO: 2009-003

FAA AIP NOS.

DESIGN: PENDING

CONSTRUCTION: PENDING

PENNDOT AGREEMENT/INTERNAL ORDER NOS.

DESIGN: PENDING

CONSTRUCTION: PENDING

DRAWING INDEX

SHEET	Description	Sheet Description
AP-01	TITLE SHEET AND DRAWING INDEX	P W05 Cover-SQAM0002
AP-02	GENERAL NOTES	P W05 Quantities-SQAM0002
AP-03	SITE PLAN	P W05 Site plan-SQAM0002
AP-04	AIRPORT OPERATIONAL SAFETY AND PHASING PLAN	P W05 Phasing-SQAM0002
AP-05	OPERATION SAFETY AND PHASING PLAN DETAILS	P W05 Phasing-SQAM0002
AP-06	GEOMETRY PLAN	P W05 Geometry-SQAM0002
AP-07	GEOMETRY CHARTS	P W05 Geometry-SQAM0002
AP-08	GRADING & DRAINAGE PLAN	P W05 Drainage-SQAM0002
AP-09	OVERALL LIMIT OF DISTURBANCE	P W05 E&S Overall-SQAM0002
AP-10	EROSION AND SEDIMENTATION CONTROL PLAN - SHEET 1 OF 2	P W05 E&S STAGE 2-SQAM0002
AP-11	EROSION AND SEDIMENTATION CONTROL PLAN - SHEET 2 OF 2	P W05 E&S STAGE 2-SQAM0002
AP-12	SEEDING PLAN	P W05 Seeding-SQAM0002
AP-13	BORING PLAN	P W05 Boring Plan-SQAM0002
AP-14	BORING LOGS	P W05 Boring Plan-SQAM0002
AP-15	TEST PIT INFORMATION	P W05 Boring Plan-SQAM0002
AP-16	PIPE PROFILES	P W05 Pipe Profiles-SQAM0002
AP-17	E & S DETAILS - SHEET 1 OF 5	P W05 E&S Details-SQAM0002
AP-18	E & S DETAILS - SHEET 2 OF 5	P W05 E&S Details-SQAM0002
AP-19	E & S DETAILS - SHEET 3 OF 5	P W05 E&S Details-SQAM0002
AP-20	E & S DETAILS - SHEET 4 OF 5	P W05 E&S Details-SQAM0002
AP-21	E & S DETAILS - SHEET 5 OF 5	P W05 E&S Details-SQAM0002
AP-22	DRAINAGE DETAILS	P W05 Details-SQAM0002
AP-23	STORMWATER MANAGEMENT DETAILS - SHEET 1 OF 2	P W05 SWM Details-SQAM0002
AP-24	STORMWATER MANAGEMENT DETAILS - SHEET 2 OF 2	P W05 SWM Details-SQAM0002
AP-25	TAXIWAY PROFILE	P W05 PROFILES-SQAM0002

CONTRACT TIME

START DATE: PENDING	120 CALENDAR DAYS
END DATE: PENDING	

*ACTUAL CONTRACT TIME WILL BE BASED ON BASE BID - MINUS DEDUCTS AWARDED (5 DAYS)

IT IS THE INTENT OF THE OWNER TO AWARD THE CONTRACT TO THE LOWEST RESPONSIBLE BIDDER PROVIDING THE BID HAS BEEN SUBMITTED IN ACCORDANCE WITH THE REQUIREMENTS OF THE BIDDING DOCUMENTS AND DOES NOT EXCEED THE FUNDS AVAILABLE. THE OWNER SHALL HAVE THE RIGHT TO WAIVE INFORMALITIES OR IRREGULARITIES IN A BID RECEIVED AND TO ACCEPT THE BID WHICH, IN THE OWNER'S JUDGMENT, IS IN THE OWNER'S BEST INTEREST. THE OWNER SHALL HAVE THE RIGHT TO DELETE ITEMS IN WHOLE OR IN PART FOR THE DURATION OF THE CONTRACT WITHOUT AFFECTING THE UNIT PRICE OF OTHER QUANTITIES, AND WITHOUT ADDITIONAL COST TO THE OWNER.

THIS DRAWING WAS PREPARED SPECIFICALLY FOR THE PROJECT AND SITE SET FORTH IN THE TITLE BLOCK AND IS NOT TO BE USED OTHERWISE WITHOUT WRITTEN APPROVAL OF

TRANSYSTEMS CORPORATION

THE PREPARATION OF THESE DRAWINGS WAS FINANCED IN PART THROUGH A GRANT FROM DOT/FAA, AND IN PART THROUGH A GRANT-IN-AID FROM THE PENNSYLVANIA DEPARTMENT OF TRANSPORTATION, BUREAU OF AVIATION.

FUNDING WAGE RATES NOTES:

1. THIS PROJECT IS ELIGIBLE FOR FEDERAL FUNDING UNDER THE FAA AIRPORT IMPROVEMENT PROGRAM. FEDERAL (DAVIS-BACON) WAGE RATES MUST BE USED FOR ALL WORK IN THIS PROJECT

RUNWAY DESIGN CODE (RDC):

- AIRCRAFT APPROACH CATEGORY - B (91 KNOTS OR MORE BUT LESS THAN 121 KNOTS)
- AIRPLANE DESIGN GROUP - II (WINGSPAN UP TO BUT NOT INCLUDING 79')
- DESIGN AIRCRAFT - II (BEECHCRAFT KING AIR B-200)

GETTYSBURG REGIONAL AIRPORT PHASE VI Contract Quantities				
Item No.	Description	Unit	Estimated Quantity	Final Quantity
Base Bid				
C-100-14.1	CONTRACTOR QUALITY CONTROL PROGRAM	LS	1	
C-102-5.1	INLET SEDIMENT FILTER	EA	6	
C-102-5.2	ROCK CONSTRUCTION ENTRANCE	EA	1	
C-102-5.3	FILTER SOCK 12"	LF	900	
C-102-5.4	ROCK, CLASS R-3 RIP RAP APRON	CY	10	
C-102-5.5	ROCK, CLASS R-4 RIP RAP APRON	CY	80	
C-102-5.6	EROSION CONTROL MULCH BLANKET	SY	2,000	
C-102-5.7	FILTER FABRIC (UNDERDRAIN WRAPPING)	SY	2,750	
C-102-5.8	GEOTEXTILE LINER (RIPRAP APRONS)	SY	140	
C-102-5.9	AGGREGATE, AASHTO #57 (BASIN BED)	CY	775	
C-105-6.1	MOBILIZATION/CONTRACTOR'S PLANT	LS	1	
C-105-6.2	HAUL ROAD	SY	570	
C-105-6.3	CONSTRUCTION SURVEYING	LS	1	
M-001-7.1	MAINTENANCE AND PROTECTION OF AIR AND VEHICLE TRAFFIC DURING CONSTRUCTION	LS	1	
M-001-7.2	TEMPORARY CONSTRUCTION FENCE (WETLAND AREA)	LF	200	
P-151-4.1	CLEARING AND GRUBBING (LIGHT)	AC	1	
P-154-4.1	2A SUBBASE COURSE, 10" DEPTH	SY	2,125	
P-152-4.1	UNCLASSIFIED EXCAVATION (REMOVED FROM SITE)	CY	5,500	
P-152-4.2	UNSUITABLE EXCAVATION	CY	400	
P-152-4.3	EMBANKMENT, CLAY CORE FOR BASIN	LS	1	
D-705-5.1	4" PERFORATED UNDERDRAIN PIPE	LF	400	
D-751-5.1	OUTLET CONTROL STRUCTURE, W/ TRASH RACK, SKIMMER, COMPLETE	EA	1	
D-751-5.2	TYPE M INLET, WITH FRAME AND GRATE	EA	3	
D-751-5.3	AIRFIELD INLET, WITH STRUCTURAL STEEL FRAME AND GRATE	EA	1	
D-701-5.1	8" ALUMINIZED TYPE 2 CORRUGATED METAL PIPE	LF	5	
D-701-5.2	10" ALUMINIZED TYPE 2 CORRUGATED METAL PIPE	LF	5	
D-701-5.3	15" SMOOTH LINED CORRUGATED PLASTIC PIPE (SLCPP)	LF	350	
D-701-5.4	18" SMOOTH LINED CORRUGATED PLASTIC PIPE (SLCPP)	LF	200	
D-701-5.5	24" SMOOTH LINED CORRUGATED PLASTIC PIPE (SLCPP)	LF	115	
D-701-5.6	30" SMOOTH LINED CORRUGATED PLASTIC PIPE (SLCPP)	LF	125	
D-701-5.7	36" REINFORCED CONCRETE PIPE (RCP)	LF	40	
D-701-5.8	23" X 14" ELLIPTICAL REINFORCED CONCRETE PIPE (RCP)	LF	250	
D-701-5.9	ANTI SEEP COLLAR	EA	1	
D-752-5.1	MODIFIED CONCRETE ENDWALL FOR 15 INCH PIPE (E-5 AND E-5A)	EA	2	
D-752-5.2	STANDARD CONCRETE ENDWALL, 30 INCH	EA	1	
D-752-5.3	MODIFIED CONCRETE ENDWALL FOR 23" X 14" ELLIPTICAL RCP	EA	2	
D-752-5.4	MODIFIED CONCRETE ENDWALL FOR DUAL 23" X 14" ELLIPTICAL RCP	EA	4	
T-901-5.1	SEEDING AND FORMULA SUPPLEMENT S, FORMULA B	AC	6	
T-901-5.2	SEEDING AND FORMULA SUPPLEMENT S, FORMULA D	AC	2	
T-905-5.1	TOPSOILING (REMOVED, STRIPPED, OR EXCAVATED)	CY	1,600	
T-905-5.2	TOPSOILINGS SPREADING (ON-SITE BORROW, 4" DEPTH)	CY	850	
T-908-5.1	WOOD FIBER MULCHING	AC	8	

GETTYSBURG REGIONAL AIRPORT PHASE VI Contract Quantities				
Item No.	Description	Unit	Estimated Quantity	Final Quantity
Deduct Alternate				
D-705-5.1	4" PERFORATED UNDERDRAIN PIPE	LF	10	
D-701-5.1	8" ALUMINIZED TYPE 2 CORRUGATED METAL PIPE	LF	5	
D-701-5.2	10" ALUMINIZED TYPE 2 CORRUGATED METAL PIPE	LF	5	
D-701-5.3	15" SMOOTH LINED CORRUGATED PLASTIC PIPE (SLCPP)	LF	5	
D-701-5.4	18" SMOOTH LINED CORRUGATED PLASTIC PIPE (SLCPP)	LF	172	
D-701-5.5	24" SMOOTH LINED CORRUGATED PLASTIC PIPE (SLCPP)	LF	100	
D-751-5.2	TYPE M INLET, WITH FRAME AND GRATE	EA	2	

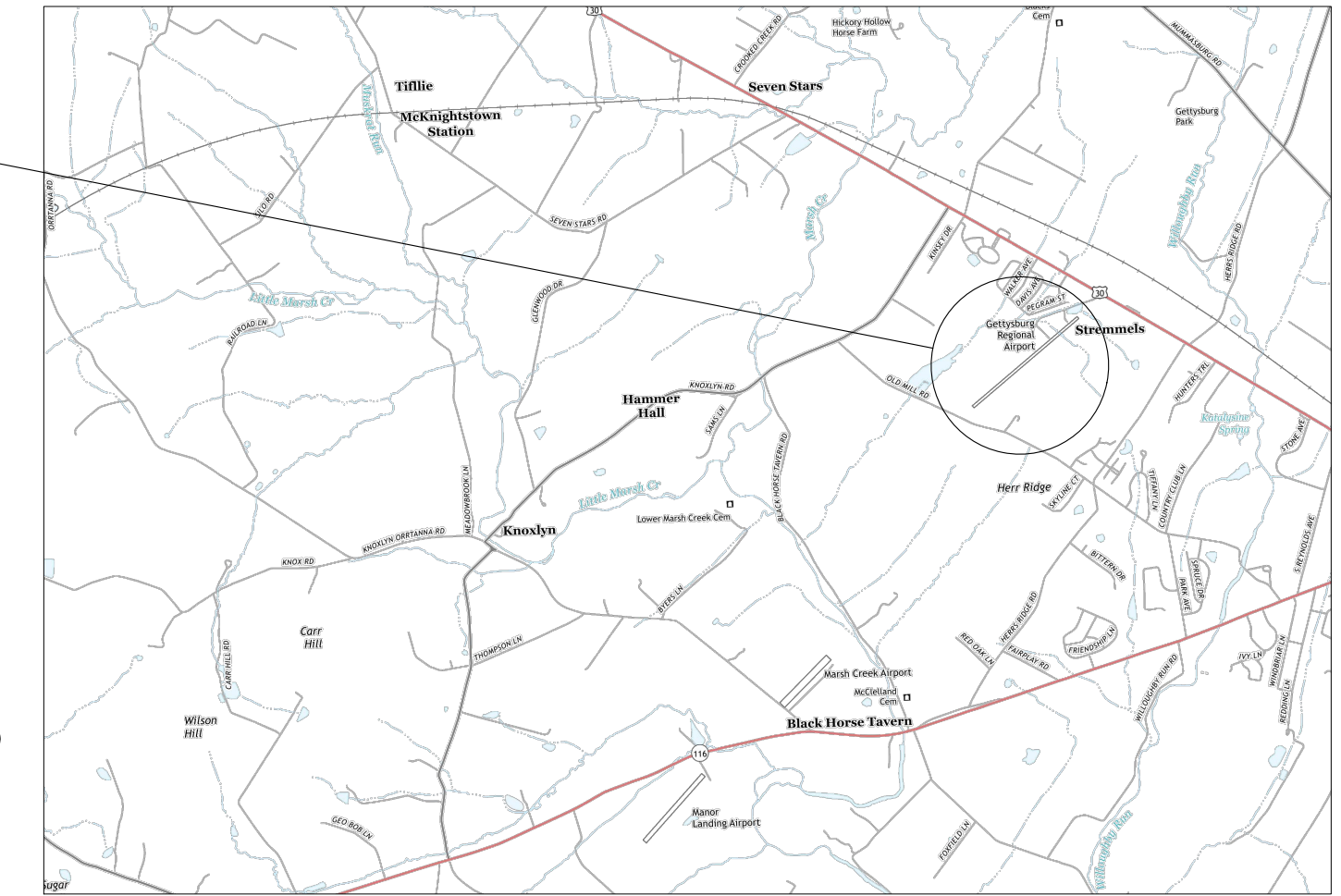

VICINITY MAP
NOT TO SCALE

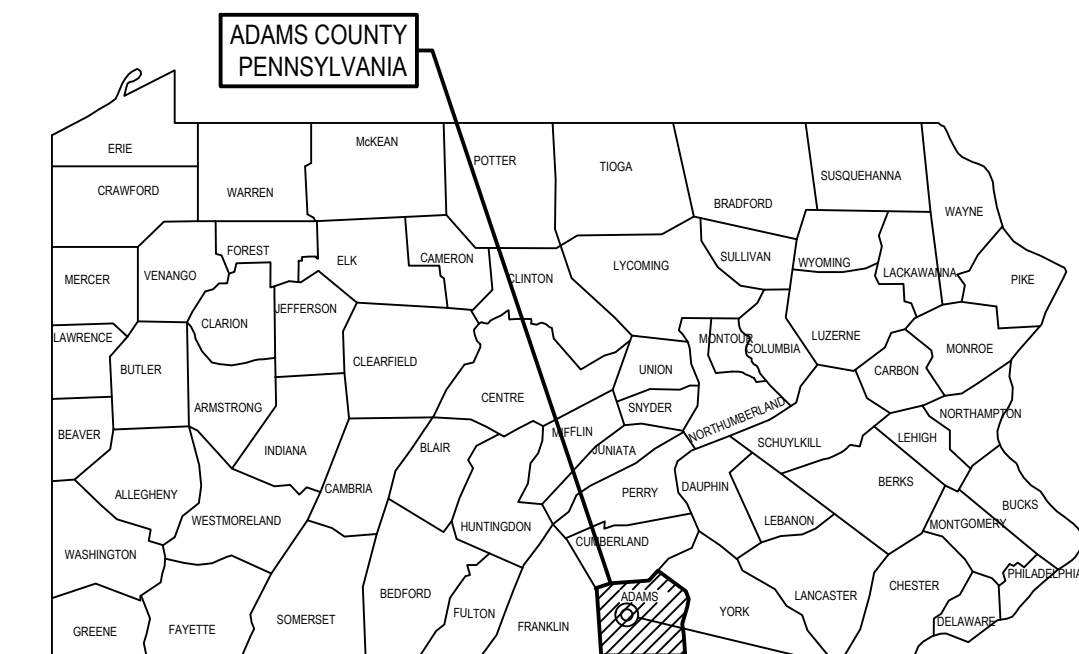

PENNSYLVANIA
PROJECT LOCATION
NOT TO SCALE

STOP - CALL US
BEFORE YOU DIG
PENNSYLVANIA ONE CALL SYSTEMS, INC.
3 BUSINESS DAYS NOTICE IS THE LAW!

8-1-1 OR 1-800-242-1776
www.paonecall.org



Know what's below.
Call before you dig.

General Utility & One Call Information:

The location of existing underground utilities are shown in an approximate way only and have not been independently verified by the Using Agency. The Contractor shall determine the exact location of all existing utilities before commencing work, and agrees to be fully responsible for any and all damages which may occur by the Contractor's failure to exactly locate and preserve any and all utilities.

Contractor shall notify the PA One Call System not less than three (3) days prior to construction. The Contractor shall place the call and provide an approximate date and time that digging will occur. The One Call System will then notify the public and private utilities in the area. Public and private utilities will then coordinate directly with the Contractor for actual field locations.

PA One Call System Phone: 8-1-1 OR 1-800-242-1776
POCS Serial Number: 20220111536-000



615 West Highland Avenue
Ebensburg, PA 15931
Phone: (814) 419-7883
Email: glschrock@transystems.com
Website: www.transystems.com

DESIGNED	MAK	7/23
DRAWN	MAK	7/23
CHECKED	GLS	7/23
APPROVED	GLS	7/23

REVISIONS			
DATE	BY	DESCRIPTION	
2/24	MAK	ADDED HAUL ROAD, REMOVED ADD ALTERNATE	
4/8/24	TJN	ADDENDUM #1	



OWNER: SUSQUEHANNA AREA
REGIONAL AIRPORT AUTHORITY
ONE TERMINAL DRIVE, SUITE 300
MIDDLETOWN, PA 17057
PHONE: 717.948.3900



TIMOTHY J. EDWARDS
EXECUTIVE DIRECTOR
tedwards@saraa.org

GETTYSBURG REGIONAL
AIRPORT (W05)

1130 CHAMBERSBURG ROAD
GETTYSBURG, PA 17325
ADAMS COUNTY
CUMBERLAND TOWNSHIP
PARCEL ID: 09E12-0107



CONSTRUCT SOUTH AIRCRAFT PARKING
APRON, PHASE VI

TITLE SHEET AND DRAWING INDEX

AP-01

PROJECT NO	P707220067	DATE	JULY 2023
------------	------------	------	-----------

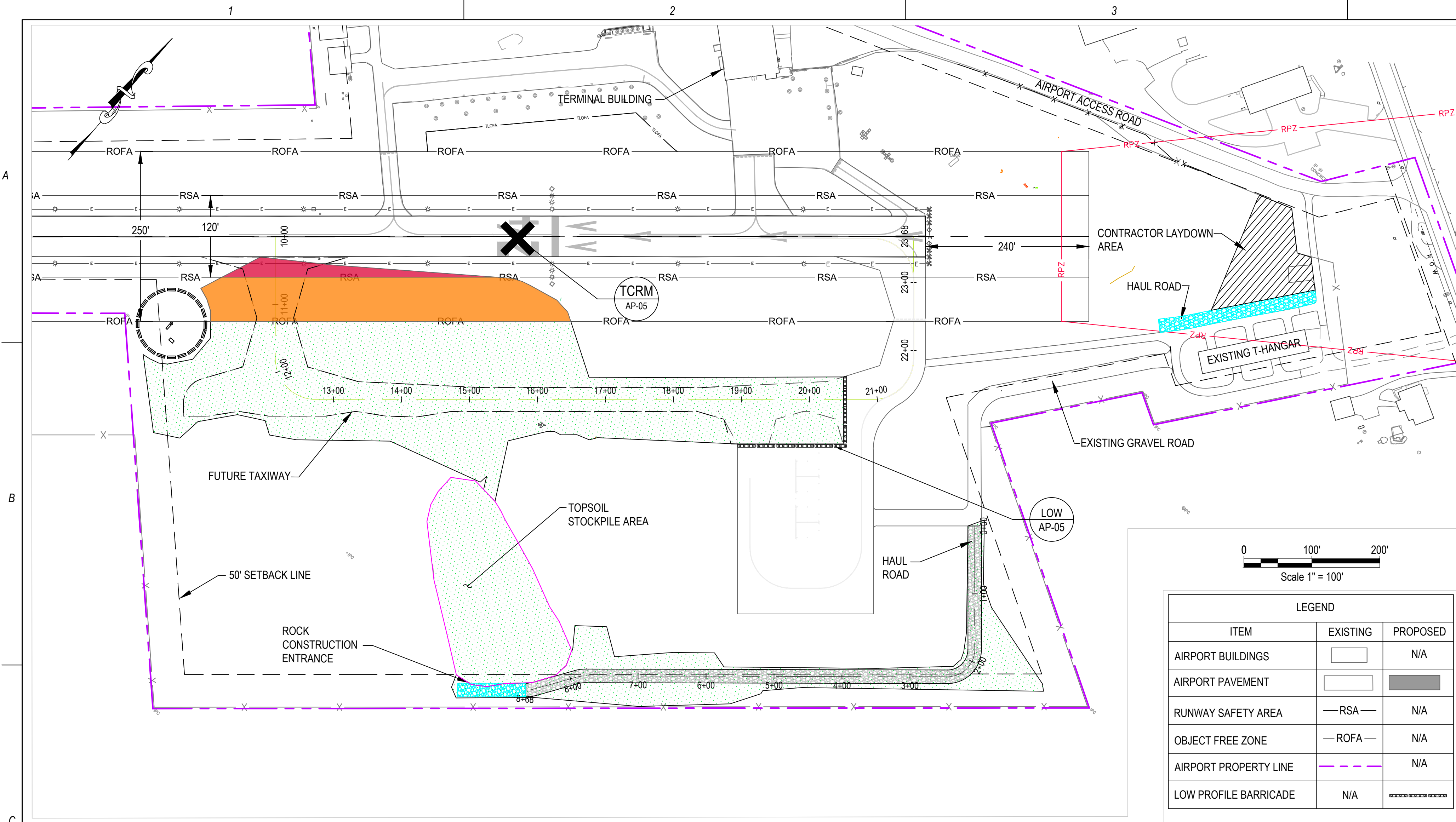

LEGEND	
	WORK AREA 1 will involve work outside / under the OFZ. When work occurs outside the OFZ and below the Inner-transitional (3:1) OFZ, work can be completed while the runway is open. This will include all work in this area.
	WORK AREA 2 will involve work inside the OFZ but outside the RSA. Because of the terrain where the runway elevation is much higher than some of the work areas, if equipment is inside the OFZ but the equipment is still below the elevation of the OFZ, that runway can also remain open.
	WORK AREA 3 will involve work within the OFZ and RSA, in this case the runway must be NOTAM closed.
	WORK AREA 4 will involve work outside / under the OFZ and within pavement boundaries.

MONITOR
 THE FOLLOWING FREQUENCIES SHALL BE MONITORED FOR EMERGENCY INSTRUCTIONS AND AIRCRAFT MOVEMENT:
122.900 MHz CTAF

- CONSTRUCTION SCHEDULE:**
- Construction will commence within the 10 day period as specified from the acceptance of the notice to proceed.
 - The contract time for construction is a total of 120 calendar days (90 work days) Deduct Alternate Bid - 5 days

DEFINITIONS

Air Operations Area (AOA) - Any area of the airport used or intended to be used for the landing, takeoff, or surface maneuvering of aircraft. An air operations area includes such paved or unpaved areas that are used or intended to be used for the unobstructed movement of aircraft in addition to its associated runways, taxiways, or aprons.

Runway Safety Area (RSA) - The RSA is a defined / graded surface surrounding the runway prepared or suitable for reducing the risk of damage to airplanes in the event of an undershoot, overshoot, or excursion from the runway. The RSA width is 120 feet (60 feet from centerline) and extends 240 feet beyond each runway end.

Runway Obstacle Free Zone (OFZ) - The Runway OFZ is a defined volume of airspace centered above the runway centerline. The Runway OFZ is the airspace above the surface whose elevation at any point is the same as the elevation of the nearest point on the Runway centerline. The OFZ width is 250 feet (125 feet from centerline) and extends 240 feet beyond each runway end. From the edge of the OFZ, the inner-transitional OFZ slopes up at 3 (horizontal) to 1 (vertical).

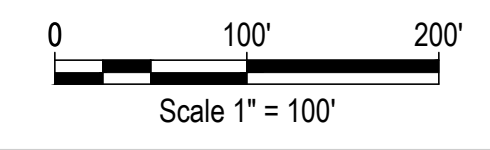

LEGEND		
ITEM	EXISTING	PROPOSED
AIRPORT BUILDINGS		N/A
AIRPORT PAVEMENT		
RUNWAY SAFETY AREA	— RSA —	N/A
OBJECT FREE ZONE	— ROFA —	N/A
AIRPORT PROPERTY LINE		N/A
LOW PROFILE BARRICADE	N/A	

A. SPECIFIC WORK AREA PHASING NOTES (SECTION 206)

- THE INTENT OF THIS PHASING PLAN IS TO MINIMIZE THE IMPACTS OF CONSTRUCTION ON THE OPERATIONS OF THE AIRPORT. ALL REQUIREMENTS CONTAINED IN THE CONSTRUCTION DOCUMENTS SHALL BE STRICTLY ENFORCED.
- ALL WORK ASSOCIATED WITH THE PROJECT SHALL BE COMPLETED AS FOLLOWS WITH LIQUIDATED DAMAGES IN THE AMOUNT OF TWO THOUSAND FIVE HUNDRED DOLLARS (\$2,500) PER CALENDAR DAY FOR EACH CALENDAR DAY THAT THE PROJECT CONTRACT TIME IS EXCEEDED BEING ASSESSED AGAINST THE CONTRACTOR. THE CALENDAR DAY STARTS AT 12:00 AM.
- MILESTONE EVENTS HAVE BEEN ESTABLISHED TO MINIMIZE IMPACT TO AIRPORT OPERATIONS. WORK IN THESE MILESTONE AREAS RESTRICTS OPERATIONAL CAPABILITY OF THE AIRPORT AND USERS. MILESTONE LIQUIDATED DAMAGES SHALL BE ASSESSED DUE TO THE COST TO THE AIRPORT AND USERS ASSOCIATED WITH CLOSURE OF THE FACILITIES BEYOND THE MILESTONE PERIOD.
- THE CONTRACTOR SHALL SUBMIT A DETAILED PROJECT SCHEDULE TO THE ENGINEER AT LEAST TEN (10) CALENDAR DAYS PRIOR TO THE PRE-CONSTRUCTION CONFERENCE. THE SCHEDULE SHALL AT A MINIMUM IDENTIFY THE MAJOR WORK AREAS AND MILESTONE EVENTS.
- UNLESS SPECIFICALLY STATED HEREIN, WORK IN MULTIPLE AREAS MAY PROCEED CONCURRENTLY PROVIDED ALL OTHER REQUIREMENTS OF THE PHASING PLANS ARE MET.
- THE WORK INCLUDES FOUR (4) **THREE (3)** PHASED MILESTONE WORK AREAS.
- AIRCRAFT TAXI ROUTES, EMERGENCY VEHICLE ACCESS ROUTES, CONSTRUCTION STAGING AREAS AND CONSTRUCTION ACCESS/HAUL ROUTES ARE DEPICTED ON THE CONSTRUCTION PHASING PLAN(S).
- CLOSURE MARKERS/BARRICADES SHALL BE PLACED ANYTIME A SECTION OF PAVEMENT IS CLOSED TO AIRCRAFT. LIGHTED CLOSURE MARKERS SHALL BE USED AT NIGHT UNLESS THE APPLICABLE NAVIGATIONAL AIDS AND LIGHTS HAVE BEEN TURNED OFF IN THE VAULT.

B. WORK AREA ONE (1):

- AREAS CLOSED TO AIRCRAFT OPERATIONS:
 - ACCESS TO PROPOSED TAXIWAY A FROM RUNWAY 6-24
- DURATION OF CLOSURE OF WORK AREA:
 - FORTY-FIVE (45) **FORTY-FOUR (44)** CALENDAR DAYS
- IMPACTS TO NAVIGATIONS:
 - NONE
- LIGHTING AND MARKINGS:
 - AS DEPICTED ON THE PHASING PLAN
- AVAILABLE RUNWAY LENGTH/DECLARED:
 - NOT APPLICABLE
- REQUIRED HAZARD MARKING AND LIGHTING:
 - AS DEPICTED ON THE PHASING PLAN
- LEAD TIMES FOR REQUIRED NOTIFICATIONS:
 - 72 HOUR
- LIQUIDATED DAMAGES
 - \$2,500 FOR EACH DAY, OR PORTION THEREOF, BEYOND THE DURATION OF CLOSURE FOR THIS WORK AREA.

C. WORK AREA TWO (2):

- AREAS CLOSED TO AIRCRAFT OPERATIONS:
 - ACCESS TO PROPOSED TAXIWAY A FROM RUNWAY 6-24
 - RUNWAY 6-24 IF EQUIPMENT IS HIGHER IN ELEVATION THAN THE OFZ
- DURATION OF CLOSURE OF WORK AREA:
 - THIRTY-FIVE (35) **TWENTY-FIVE (25)** CALENDAR DAYS
- IMPACTS TO NAVIGATIONS:
 - TURNED OFF IF THE RUNWAY IS CLOSED
- LIGHTING AND MARKINGS:
 - AS DEPICTED ON THE PHASING PLAN
 - LIGHTS TO BE TURNED OFF IF THE RUNWAY IS CLOSED
- AVAILABLE RUNWAY LENGTH/DECLARED:
 - NOT APPLICABLE
- REQUIRED HAZARD MARKING AND LIGHTING:
 - AS DEPICTED ON THE PHASING PLAN
- LEAD TIMES FOR REQUIRED NOTIFICATIONS:
 - 72 HOUR
- LIQUIDATED DAMAGES
 - \$2,500 FOR EACH DAY, OR PORTION THEREOF, BEYOND THE DURATION OF CLOSURE FOR THIS WORK AREA.

D. WORK AREA THREE (3):

- AREAS CLOSED TO AIRCRAFT OPERATIONS:
 - RUNWAY 6-24
- DURATION OF CLOSURE OF WORK AREA:
 - TEN (10) CALENDAR DAYS
- IMPACTS TO NAVIGATIONS:
 - TURNED OFF
- LIGHTING AND MARKINGS:
 - AS DEPICTED ON THE PHASING PLAN
 - LIGHTS TO BE TURNED OFF
- AVAILABLE RUNWAY LENGTH/DECLARED:
 - NOT APPLICABLE
- REQUIRED HAZARD MARKING AND LIGHTING:
 - AS DEPICTED ON THE PHASING PLAN
- LEAD TIMES FOR REQUIRED NOTIFICATIONS:
 - 72 HOUR
- LIQUIDATED DAMAGES
 - \$2,500 FOR EACH DAY, OR PORTION THEREOF, BEYOND THE DURATION OF CLOSURE FOR THIS WORK AREA.

E. WORK AREA FOUR (4):

- AREAS CLOSED TO AIRCRAFT OPERATIONS:
 - ACCESS TO PROPOSED TAXIWAY A FROM RUNWAY 6-24
- DURATION OF CLOSURE:
 - NONE
- IMPACTS TO NAVIGATIONS:
 - NONE
- LIGHTING AND MARKINGS:
 - AS DEPICTED ON THE PHASING PLAN
- AVAILABLE RUNWAY LENGTH/DECLARED:
 - NOT APPLICABLE
- REQUIRED HAZARD MARKING AND LIGHTING:
 - AS DEPICTED ON THE PHASING PLAN
- LEAD TIMES FOR REQUIRED NOTIFICATIONS:
 - 72 HOUR
- LIQUIDATED DAMAGES
 - \$2,500 FOR EACH DAY, OR PORTION THEREOF, BEYOND THE DURATION OF CLOSURE FOR THIS WORK AREA.

AS-BUILT PLANS

THE CONTRACTOR SHALL PREPARE A SURVEYED AS-BUILT FOR CONSTRUCTION INCLUDING, AT A MINIMUM, THE INFORMATION WITHIN THE CUMBERLAND TOWNSHIP SUBDIVISION AND LAND DEVELOPMENT ORDINANCE SECTION 22-310 AND PROVIDE COPIES TO THE OWNER, ENGINEER, AND CUMBERLAND TOWNSHIP.

615 West Highland Avenue
 Ebensburg, PA 15931
 Phone: (814) 419-7883
 Email: glschrock@transystems.com
 Website: www.transystems.com

© TRANSYSTEMS CORPORATION formerly L.R. Kimball

DESIGNED	MAK	7/23
DRAWN	MAK	7/23
CHECKED	GLS	7/23
APPROVED	GLS	7/23

REVISIONS		
DATE	BY	DESCRIPTION
2/24	MAK	ADDED HAUL ROAD, REMOVED ADD ALTERNATE
4/8/24	TJN	ADDENDUM #1

OWNER: SUSQUEHANNA AREA REGIONAL AIRPORT AUTHORITY
 ONE TERMINAL DRIVE, SUITE 300
 MIDDLETOWN, PA 17057
 PHONE: 717.948.3900

GETTYSBURG REGIONAL AIRPORT (W05)

1130 CHAMBERSBURG ROAD
 GETTYSBURG, PA 17325
 ADAMS COUNTY
 CUMBERLAND TOWNSHIP
 PARCEL ID: 09E12-0107

SARAA SUSQUEHANNA AREA REGIONAL AIRPORT AUTHORITY
 TIMOTHY J. EDWARDS EXECUTIVE DIRECTOR tedwards@saraa.org
 LOUIS J. PIROZZI, PE DEPUTY DIRECTOR OF ENGINEERING & PLANNING louis.pirozzi@saraa.org

CONSTRUCT SOUTH AIRCRAFT PARKING APRON, PHASE VI

AIRPORT OPERATIONAL SAFETY AND PHASING PLAN

AP-04

PROJECT NO	P707220067	DATE	JULY 2023
------------	------------	------	-----------

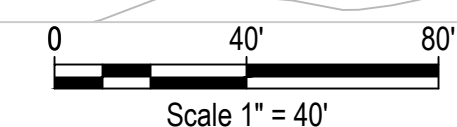
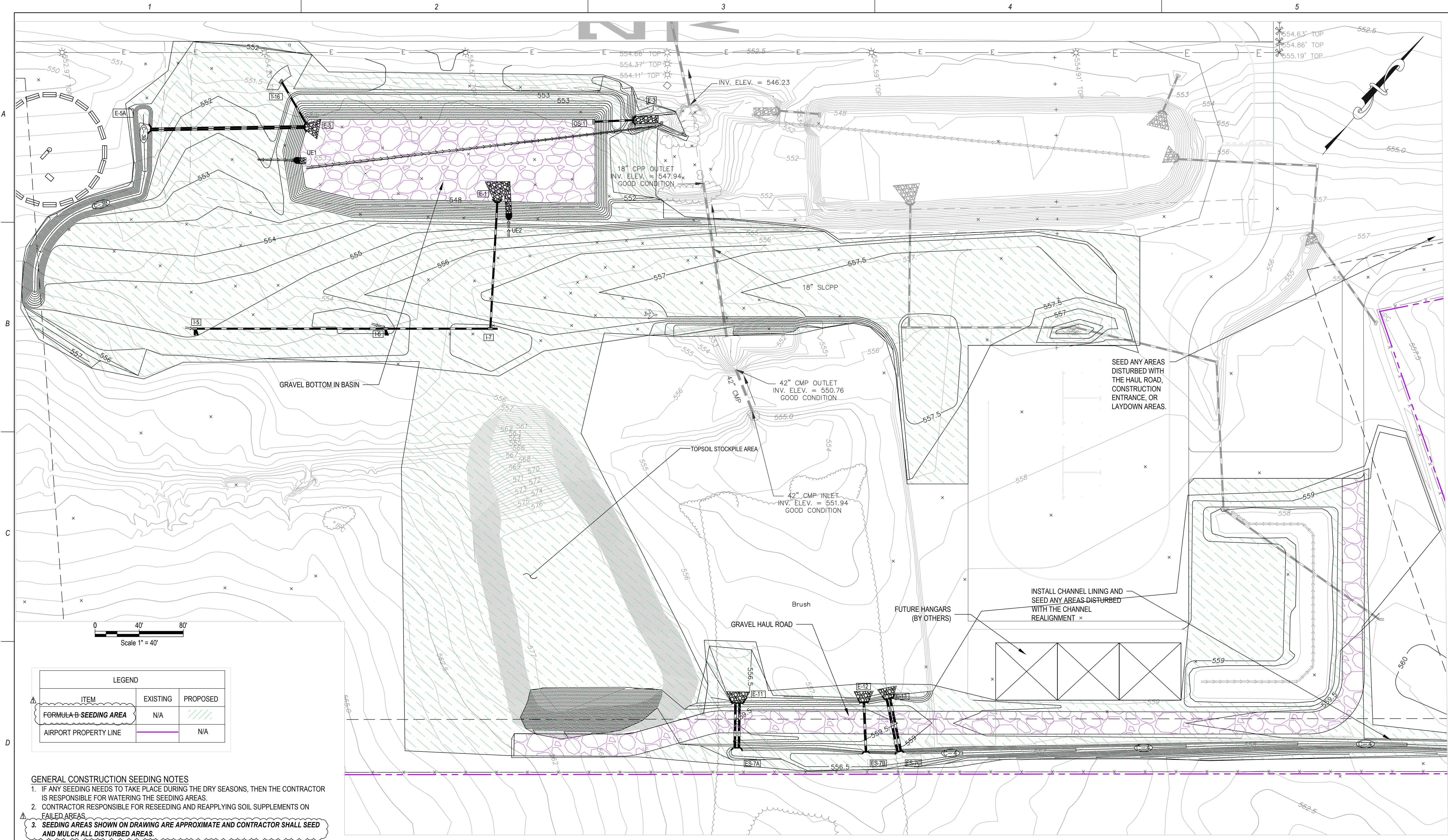

LEGEND		
ITEM	EXISTING	PROPOSED
FORMULA B SEEDING AREA	N/A	
AIRPORT PROPERTY LINE		N/A

- GENERAL CONSTRUCTION SEEDING NOTES**
- IF ANY SEEDING NEEDS TO TAKE PLACE DURING THE DRY SEASONS, THEN THE CONTRACTOR IS RESPONSIBLE FOR WATERING THE SEEDING AREAS.
 - CONTRACTOR RESPONSIBLE FOR RESEEDING AND REAPPLYING SOIL SUPPLEMENTS ON FAILED AREAS.
 - SEEDING AREAS SHOWN ON DRAWING ARE APPROXIMATE AND CONTRACTOR SHALL SEED AND MULCH ALL DISTURBED AREAS.**



615 West Highland Avenue
Ebensburg, PA 15931
Phone: (814) 419-7883
Email: gischrock@transystems.com
Website: www.transystems.com

© TRANSYSTEMS CORPORATION formerly L.R. Kimball

DESIGNED	MAK	7/23
DRAWN	MAK	7/23
CHECKED	GLS	7/23
APPROVED	GLS	7/23

REVISIONS		
DATE	BY	DESCRIPTION
2/24	MAK	ADDED HAUL ROAD, REMOVED ADD ALTERNATE
4/8/24	TJN	ADDENDUM #1

OWNER: SUSQUEHANNA AREA REGIONAL AIRPORT AUTHORITY ONE TERMINAL DRIVE, SUITE 300 MIDDLETOWN, PA 17057 PHONE: 717.948.3900	GETTYSBURG REGIONAL AIRPORT (W05)  TIMOTHY J. EDWARDS EXECUTIVE DIRECTOR tedwards@saraa.org LOUIS J. PIROZZI, PE DEPUTY DIRECTOR OF ENGINEERING & PLANNING louis.pirozzi@saraa.org
--	--

1130 CHAMBERSBURG ROAD
GETTYSBURG, PA 17325
ADAMS COUNTY
CUMBERLAND TOWNSHIP
PARCEL ID: 09E12-0107



CONSTRUCT SOUTH AIRCRAFT PARKING APRON, PHASE VI		AP-12	
SEEDING PLAN			
PROJECT NO	P707220067	DATE	JULY 2023

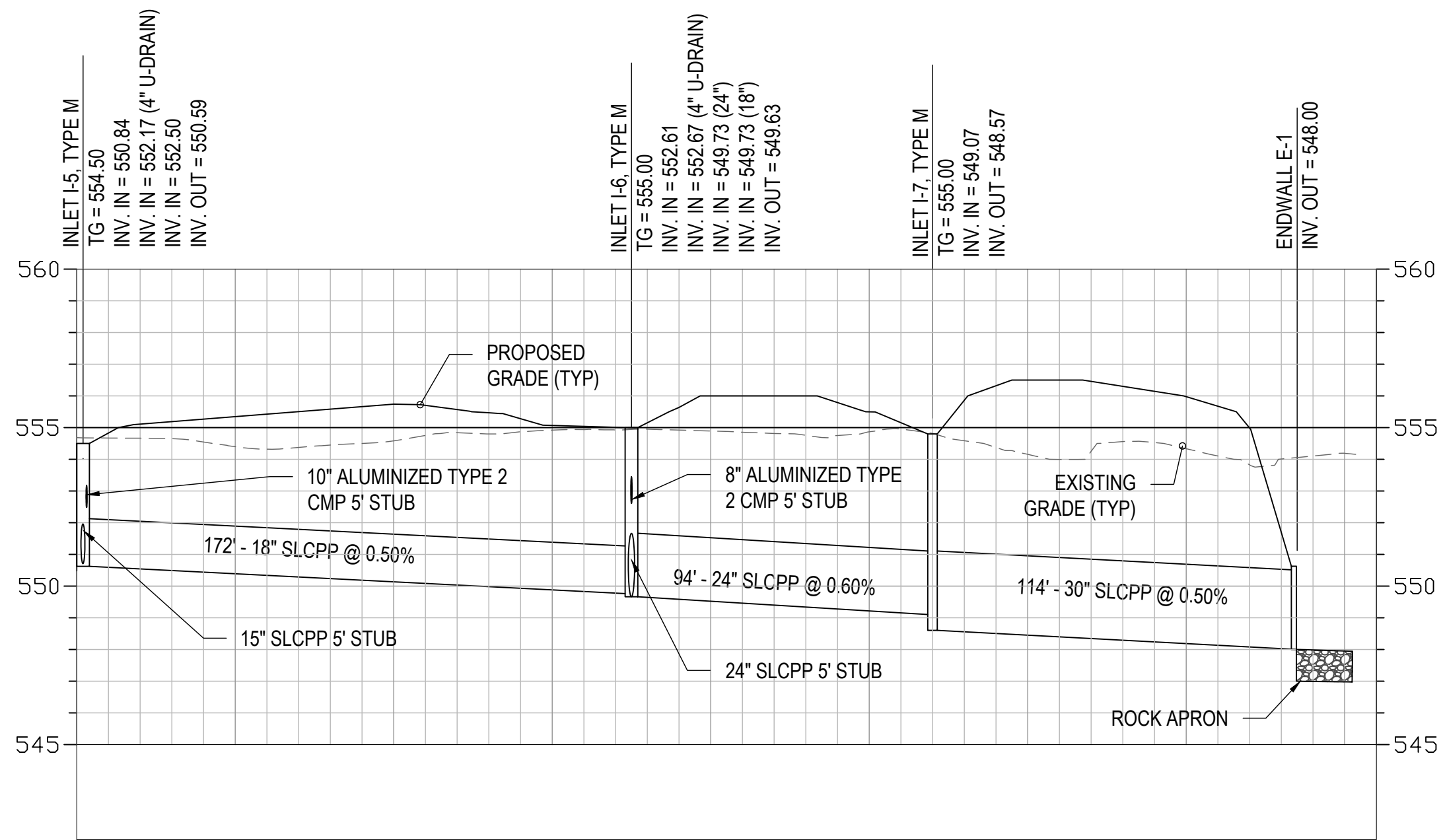

I-5 to I-6 to I-7 to E-1
 HORIZONTAL SCALE: 1" = 40'
 VERTICAL SCALE: 1" = 4'

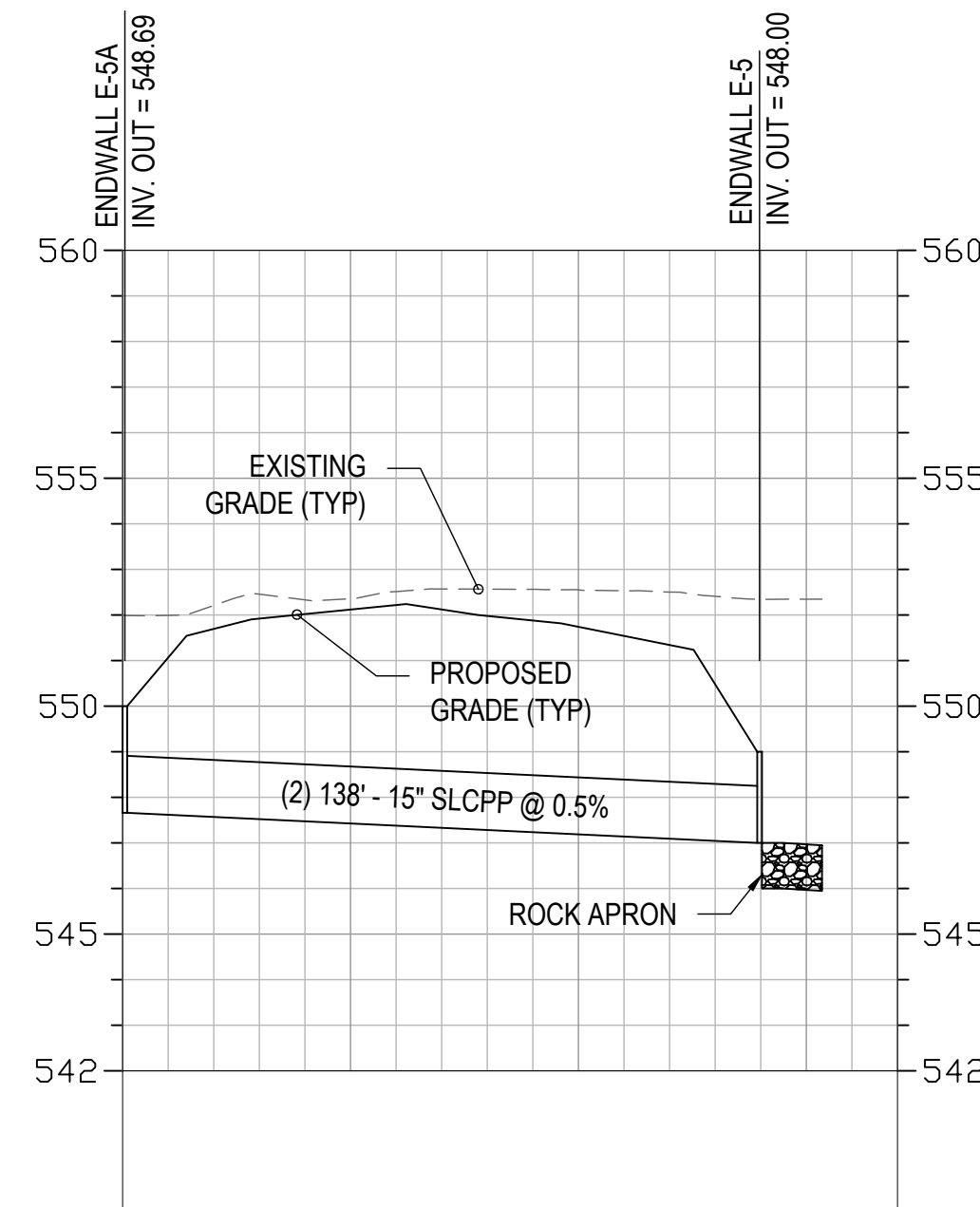

E-5A to E-5
 HORIZONTAL SCALE: 1" = 40'
 VERTICAL SCALE: 1" = 4'

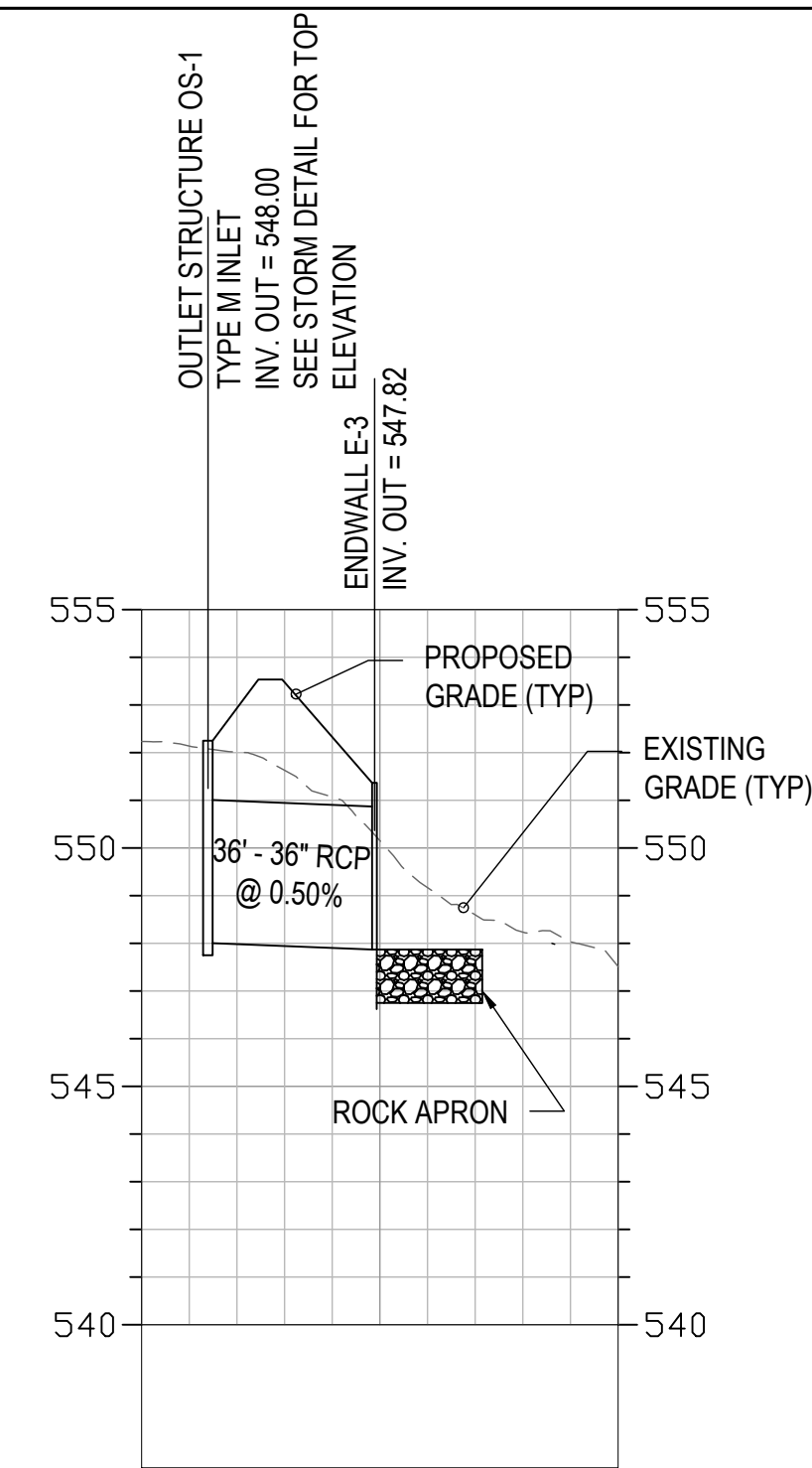

OS-1 to E-3
 HORIZONTAL SCALE: 1" = 40'
 VERTICAL SCALE: 1" = 4'

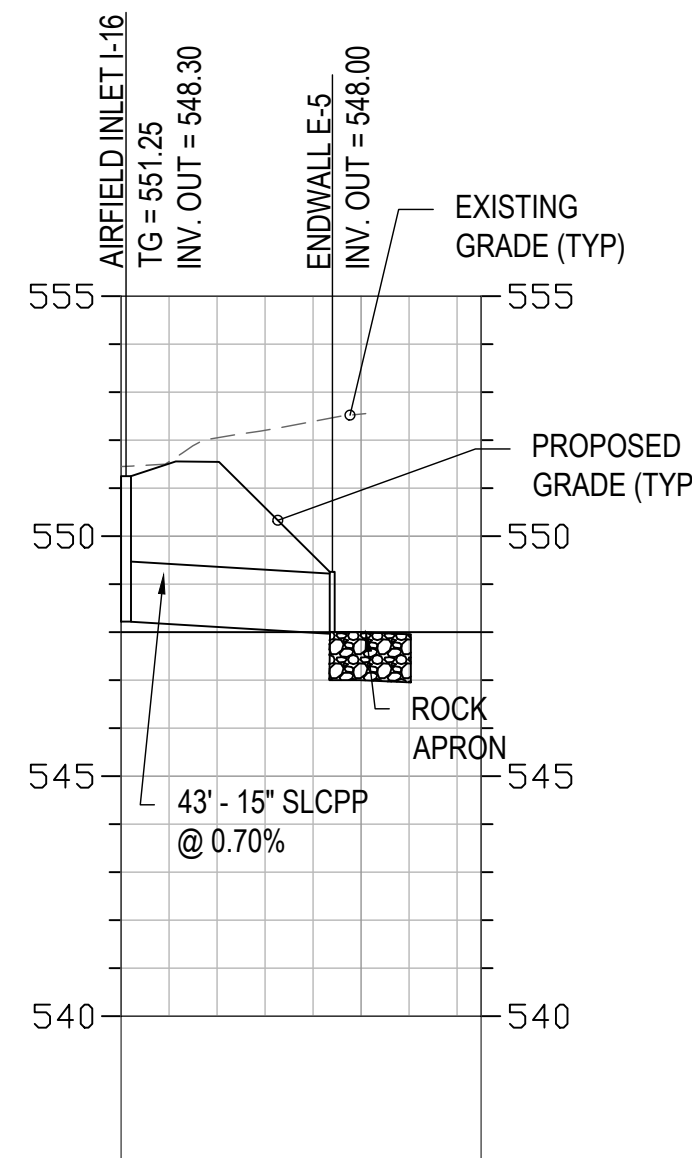

I-16 TO E-5
 HORIZONTAL SCALE: 1" = 40'
 VERTICAL SCALE: 1" = 4'

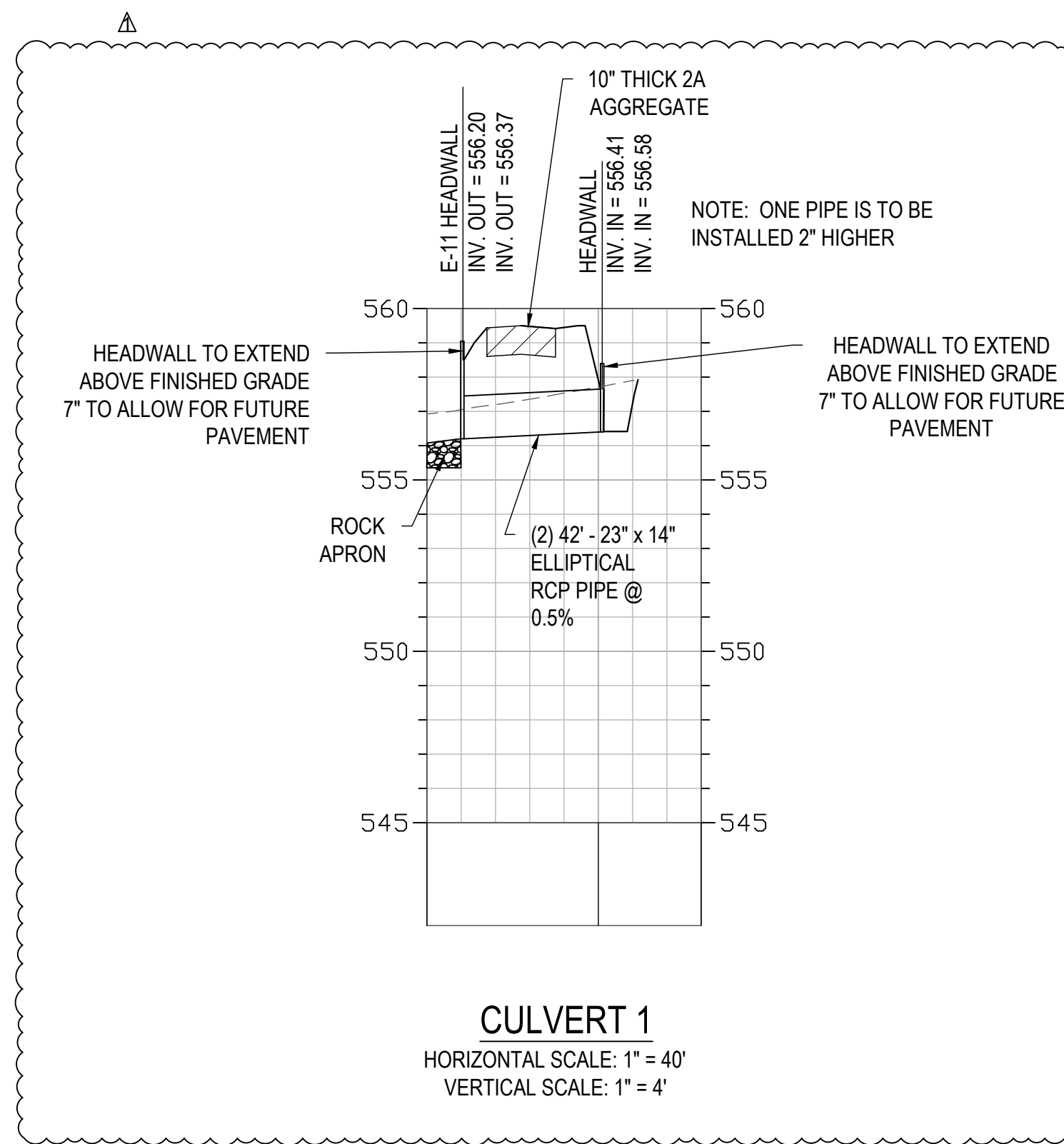

CULVERT 1
 HORIZONTAL SCALE: 1" = 40'
 VERTICAL SCALE: 1" = 4'

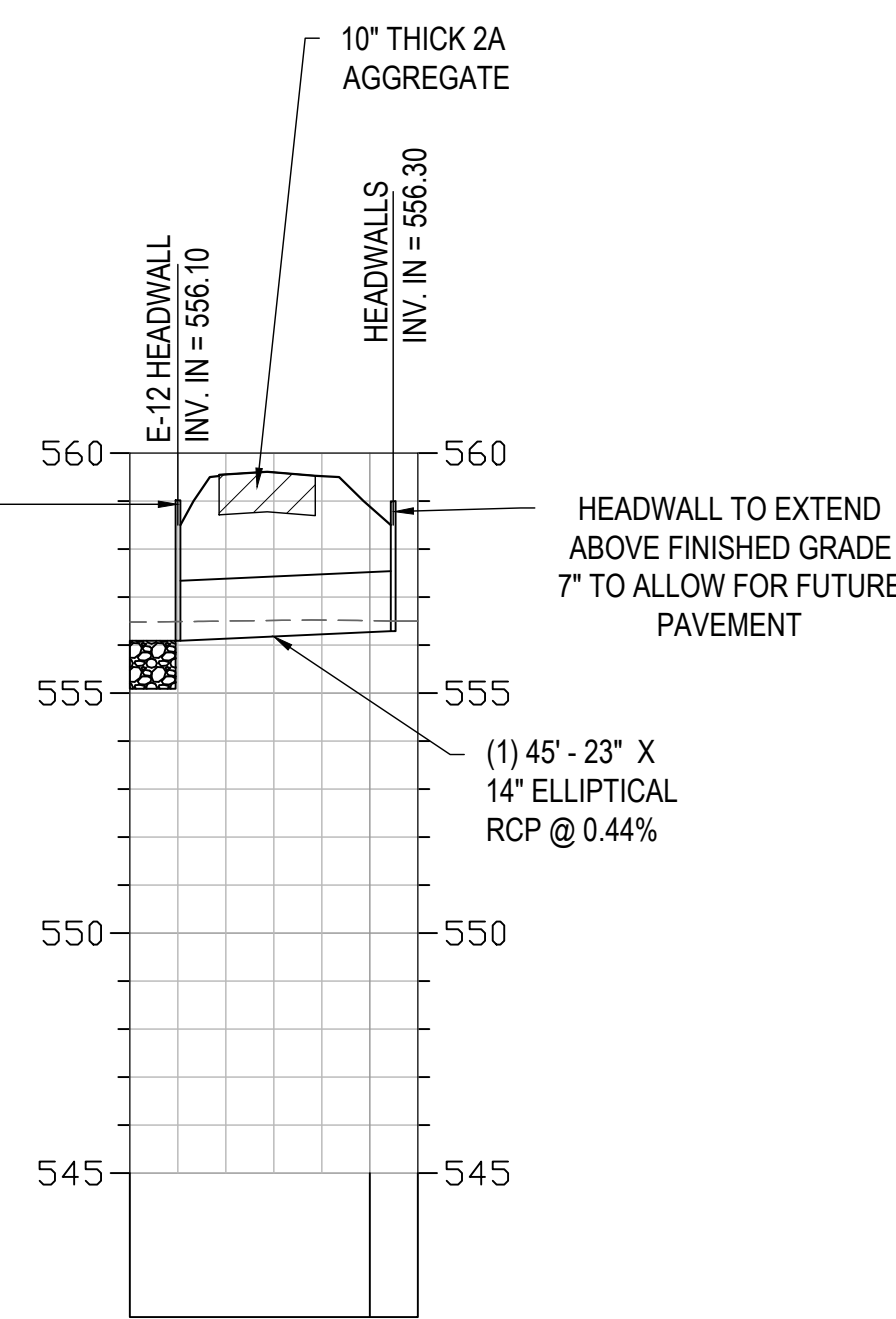

CULVERT 2A
 HORIZONTAL SCALE: 1" = 40'
 VERTICAL SCALE: 1" = 4'

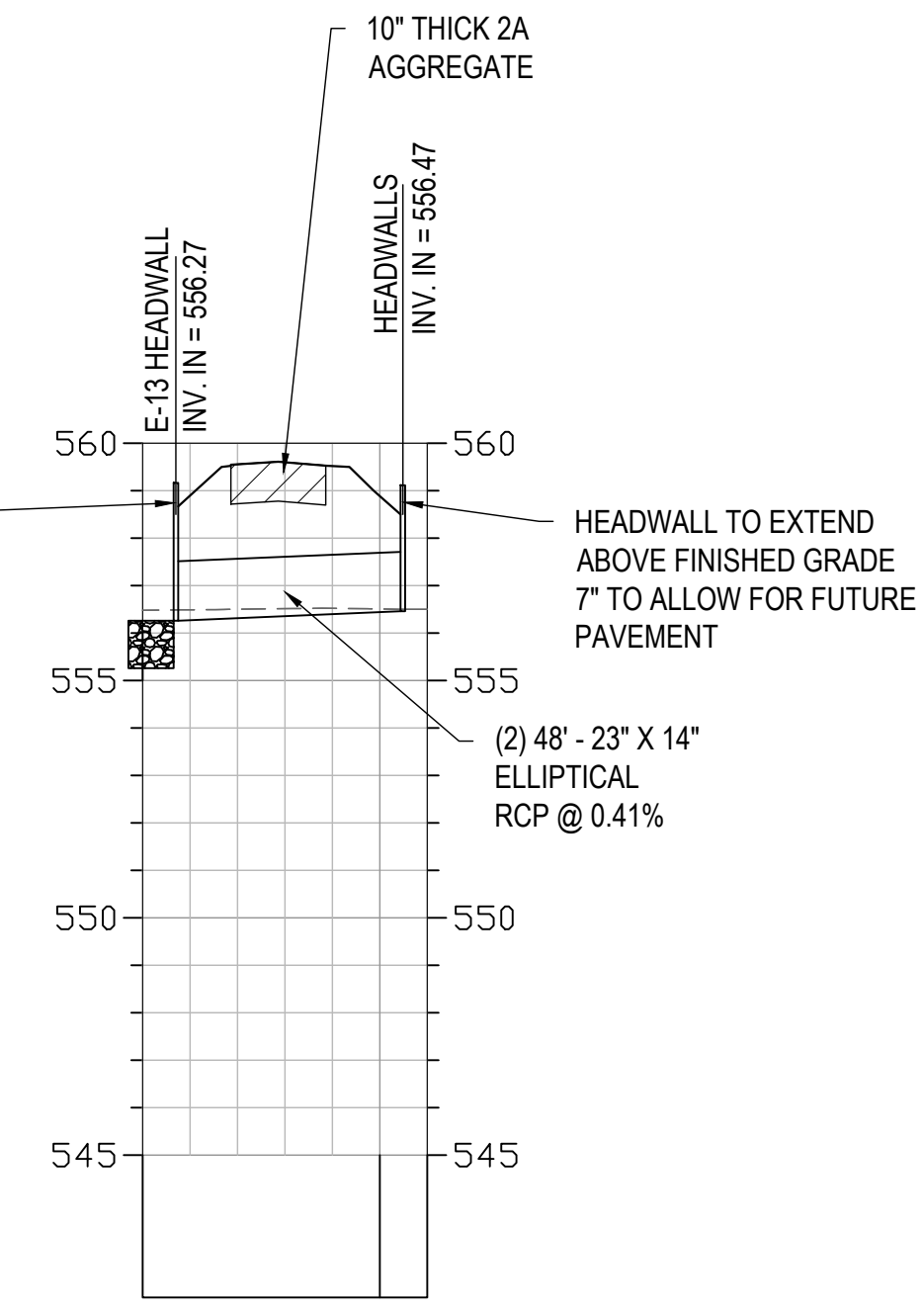

CULVERT 2B
 HORIZONTAL SCALE: 1" = 40'
 VERTICAL SCALE: 1" = 4'



615 West Highland Avenue
 Ebensburg, PA 15931
 Phone: (814) 419-7883
 Email: glschrock@transystems.com
 Website: www.transystems.com

DESIGNED	MAK	7/23
		DATE
DRAWN	MAK	7/23
		DATE
CHECKED	GLS	7/23
		DATE
APPROVED	GLS	7/23
		DATE

REVISIONS		
DATE	BY	DESCRIPTION
2/24	MAK	ADDED HAUL ROAD, REMOVED ADD ALTERNATE
4/8/24	TJN	ADDENDUM #1

OWNER: SUSQUEHANNA AREA
 REGIONAL AIRPORT AUTHORITY
 ONE TERMINAL DRIVE, SUITE 300
 MIDDLETOWN, PA 17057
 PHONE: 717.948.3900



**GETTYSBURG REGIONAL
 AIRPORT (W05)**

TIMOTHY J. EDWARDS
 EXECUTIVE DIRECTOR
 tedwards@saraa.org

LOUIS J. PIROZZI, PE
 DEPUTY DIRECTOR OF
 ENGINEERING & PLANNING
 louis.pirozzi@saraa.org

1130 CHAMBERSBURG ROAD
 GETTYSBURG, PA 17325
 ADAMS COUNTY
 CUMBERLAND TOWNSHIP
 PARCEL ID: 09E12-0107



**CONSTRUCT SOUTH AIRCRAFT PARKING
 APRON, PHASE VI**

PIPE PROFILES

AP-16

PROJECT NO	P707220067	DATE	JULY 2023
------------	------------	------	-----------

MAINTENANCE PROGRAM

MAINTENANCE OF TEMPORARY CONTROLS: UNTIL THE SITE IS STABILIZED, IT SHALL BE THE RESPONSIBILITY OF THE CONTRACTOR TO PROPERLY MAINTAIN ALL EROSION AND SEDIMENTATION CONTROL BMP'S. CONTRACTOR IS RESPONSIBLE TO PAY FOR ANY EROSION AND SEDIMENTATION CONTROL VIOLATIONS ON SITE. MAINTENANCE MUST INCLUDE INSPECTIONS OF ALL EROSION AND SEDIMENTATION BMP'S AFTER EACH RUNOFF EVENT AND ON A WEEKLY BASIS. ALL PREVENTATIVE AND REMEDIAL MAINTENANCE WORK, INCLUDING CLEAN OUT, REPAIR, REPLACEMENT, RE-GRADING, RESEEDING, RE-MULCHING, AND RE-NETTING MUST BE PERFORMED IMMEDIATELY. IF EROSION AND SEDIMENTATION CONTROL BMP'S FAIL TO PERFORM AS EXPECTED, REPLACEMENT BMP'S OR MODIFICATIONS OF THOSE INSTALLED WILL BE REQUIRED. RESPONSIBILITIES SHALL INCLUDE, BUT NOT LIMITED TO THE FOLLOWING:

REMOVAL OF PONDED WATER. INSPECT ANY LOW LYING AREAS, AS WELL AS ANY STRUCTURAL AREAS WHICH WATER COULD ACCUMULATE IN. PUMPED WATER FILTER BAGS MAY BE USED TO DEWATER SUCH AREAS AND FILTER SILT LADEN WATER FROM DISTURBED AREAS, PRIOR TO DISCHARGING TO WATERS OF THE COMMONWEALTH BY WAY OF THE ON-SITE STORMWATER COLLECTION SYSTEM. PUMPED WATER FILTER BAGS SHALL BE INSTALLED AND IMPLEMENTED IN ACCORDANCE WITH THE DETAILS SHOWN ON THE EROSION AND SEDIMENTATION CONTROL PLAN DRAWINGS.

DAILY SEDIMENT REMOVAL. THE CONTRACTOR SHALL BE RESPONSIBLE FOR THE DAILY REMOVAL OF ANY SEDIMENT DEPOSITED ON PUBLIC ROADS AND RETURN TO THE CONSTRUCTION SITE. WASHING OF THE ROADWAY WITH WATER WILL BE UNACCEPTABLE.

INSPECTION AND MAINTENANCE OF INLET PROTECTION. REMOVE SEDIMENT LOADS AND REPAIR AS NEEDED. SEDIMENT MUST BE REMOVED WHEN IT REACHES 1/2 SACK HEIGHT.

ROCK CONSTRUCTION ENTRANCE. ROCK CONSTRUCTION ENTRANCE THICKNESS SHALL BE CONSTANTLY MAINTAINED TO THE SPECIFIED DIMENSIONS BY ADDING ROCK. A STOCKPILE SHALL BE MAINTAINED ON SITE FOR THIS PURPOSE. AT THE END OF EACH CONSTRUCTION DAY, ANY SEDIMENT DEPOSITED ON PAVED ROADWAYS SHALL BE COMPLETELY REMOVED AND RETURNED TO THE CONSTRUCTION SITE.

AN ADEQUATE SUPPLY OF ADDITIONAL EROSION/SEDIMENTATION CONTROL MATERIALS (INCLUDING, BUT NOT LIMITED TO, COMPOST FILTER SOCKS, INLET PROTECTION, TEMPORARY SEED, SAND BAGS, ROCKS, AND GRAVEL) SHALL BE STOCKPILED AND ARE TO BE USED IN THE EVENT THAT EMERGENCY REPAIRS OF SOIL EROSION/SEDIMENTATION CONTROLS ARE REQUIRED.

MAINTENANCE OF PERMANENT CONTROLS: AFTER FINISHED SUB-GRADES ARE CONSTRUCTED, LEAVE TEMPORARY CONTROLS IN PLACE. TOPSOIL WILL BE SPREAD. SOIL SUPPLEMENTS WILL BE ADDED AND THE AREA WILL BE RAKED SMOOTH.

ANY STABILIZED AREAS DISTURBED DURING THE MAINTENANCE ACTIVITIES SHALL BE IMMEDIATELY STABILIZED WITH THE DESIGN STABILIZATION OF THE AREA.

ALL INSPECTIONS SHALL BE LOGGED ONTO PADEP FORM 3800-FM-BCW0271B DATED 12/20/19 AND KEPT ON SITE AT ALL TIMES.

A COPY OF SIGNED AND SEALED PLANS SHALL BE KEPT ON SITE AT ALL TIMES THROUGHOUT THE CONSTRUCTION OF THE PROJECT.

ENVIRONMENTAL DUE DILIGENCE

PERSONS APPLYING FOR AN NPDES PERMIT FOR STORMWATER DISCHARGES ASSOCIATED WITH CONSTRUCTION ACTIVITIES ARE REQUIRED TO EMPLOY ENVIRONMENTAL DUE DILIGENCE TO DETERMINE IF PAST AND PRESENT LAND USE MAY HAVE RESULTED IN THE POSSIBILITY OF CONTAMINATION ON SITE. EXAMPLES OF ENVIRONMENTAL DUE DILIGENCE, INCLUDE BUT ARE NOT LIMITED TO:

1. DETERMINING PREVIOUS USES OF THE LAND, OR OF ANY NEIGHBORING LAND.
2. DETERMINING IF THE SITE HAS THE POTENTIAL TO BE CONTAMINATED BASED ON PAST ACTIVITIES.
3. CHECKING WITH LOCAL GOVERNMENT ENTITIES FOR ANY INFORMATION THAT MAY BE AVAILABLE ABOUT THE AREA.
4. CONTACTING AGENCIES THAT MAY HAVE DEALINGS WITH CONTAMINATED SITES AND GATHERING ANY AVAILABLE INFORMATION FOR THE SITE IN QUESTION.
5. PERFORMING A SITE INSPECTION/INVESTIGATION BY AN EXPERIENCED PRACTITIONER SINCE THE LEVEL OF RISK CAN ONLY BE ASSESSED ON A SITE-BY-SITE BASIS. NOTE, THIS MAY BE THE SAME AS PERFORMING A SITE CHARACTERIZATION.

ENVIRONMENTAL DUE DILIGENCE----REGARDING CLEAN FILL, INVESTIGATIVE TECHNIQUES, INCLUDING BUT NOT LIMITED TO, VISUAL PROPERTY INSPECTIONS, ELECTRONIC DATA BASE SEARCHES, REVIEW OF PROPERTY OWNERSHIP, REVIEW OF PROPERTY USE HISTORY, SANBORN MAPS, ENVIRONMENTAL QUESTIONNAIRES, TRANSACTION SCREENS, ANALYTICAL TESTING, ENVIRONMENTAL ASSESSMENTS OR AUDITS.

CONSTRUCTION SEQUENCE

STAGE 1

1. All earth disturbance activities shall proceed in accordance with the following sequence. Each stage shall be completed before any following stage is initiated. Clearing and grubbing shall be limited only to those areas described in each stage.
2. An on-site pre-construction meeting is required to occur no less than 7-days prior to any earth disturbance unless notified otherwise by SERO DEP or the Adams County Conservation District. Permittees, co-permittees, operators, all appropriate municipal officials, representatives from the Adams County Conservation District and the SERO DEP, and licensed professionals or designees responsible for earth disturbance activity, including implementation of E & S and PCSM Plans and critical stages of implementation of the approved PCSM Plan, shall attend a pre-construction meeting.
3. Stake out the Limit of Disturbance (*as relevant to the project area*), identify and install wetland protection fence around the existing wetlands to be protected, and install the rock construction entrances and haul road as shown on the plans.
4. Install the compost filter socks and inlet protection as shown on the plans.
5. Establish the contractor staging and stockpile areas as shown on the plans.
6. Stabilize all areas, with appropriate seed and mulch, that were disturbed with the installation of the erosion and sedimentation controls including compost filter socks, rock construction entrance, and laydown areas.
7. Contractor shall provide additional erosion and sedimentation control devices as necessary based on site conditions and weather patterns during construction.
8. Clear and grub the areas to be disturbed per the Erosion and Sedimentation Control Plan (*as relevant to the project area*). Do not disturb the existing access drive and hangars in place.
9. Beginning at the downstream end, install the 3 culverts with associated headwalls and outlet protection aprons for the construction access and regrade Channel C-4. Install the construction access road and construction entrance at the end of the road.
10. **CRITICAL STAGE OF IMPLEMENTATION:** Construct Sediment Basin 1, including outfall structures, outlet protection, clay cores, anti-seep collars, etc. Do not install aggregate bed and underdrain at this time, these will be installed after the site is properly stabilized. Temporarily cover the permanent orifices of the control structure that the skimmer is not attached to with marine grade plywood. Fasten to control structure with screws and caulk.
11. Grade the site as shown on the Erosion and Sedimentation Control Plan and stabilize the site with seed and mulch. Beginning at the downstream end, install Channel 3B (with lining), storm sewer conveyance system, structures with inlet protection, underdrains not in located in the basin, and outfall protections as shown on the Erosion and Sedimentation Control Plan. Seed and mulch all areas with appropriate temporary seed and mulch.
12. No more than 15,000 square feet of disturbed area shall reach final grade before initiating seeding and mulching operations. If at any time work ceases for a period of 4 days or longer, all disturbed areas shall be temporarily stabilized.
13. Seed and mulch all disturbed areas with appropriate seed and mulch.
14. **CRITICAL STAGE OF IMPLEMENTATION:** Once the contributory area to the sediment basin has achieved proper vegetative cover, clean any remaining sediment from the basin, scarify the bottom and sides of the basin, and install the aggregate bed and underdrain.
15. Maintain erosion and sedimentation control devices until declared satisfactory by the engineer or county conservation district. Once the engineer or county conservation district considers the site satisfactorily stabilized, the erosion and sedimentation control devices can be removed.

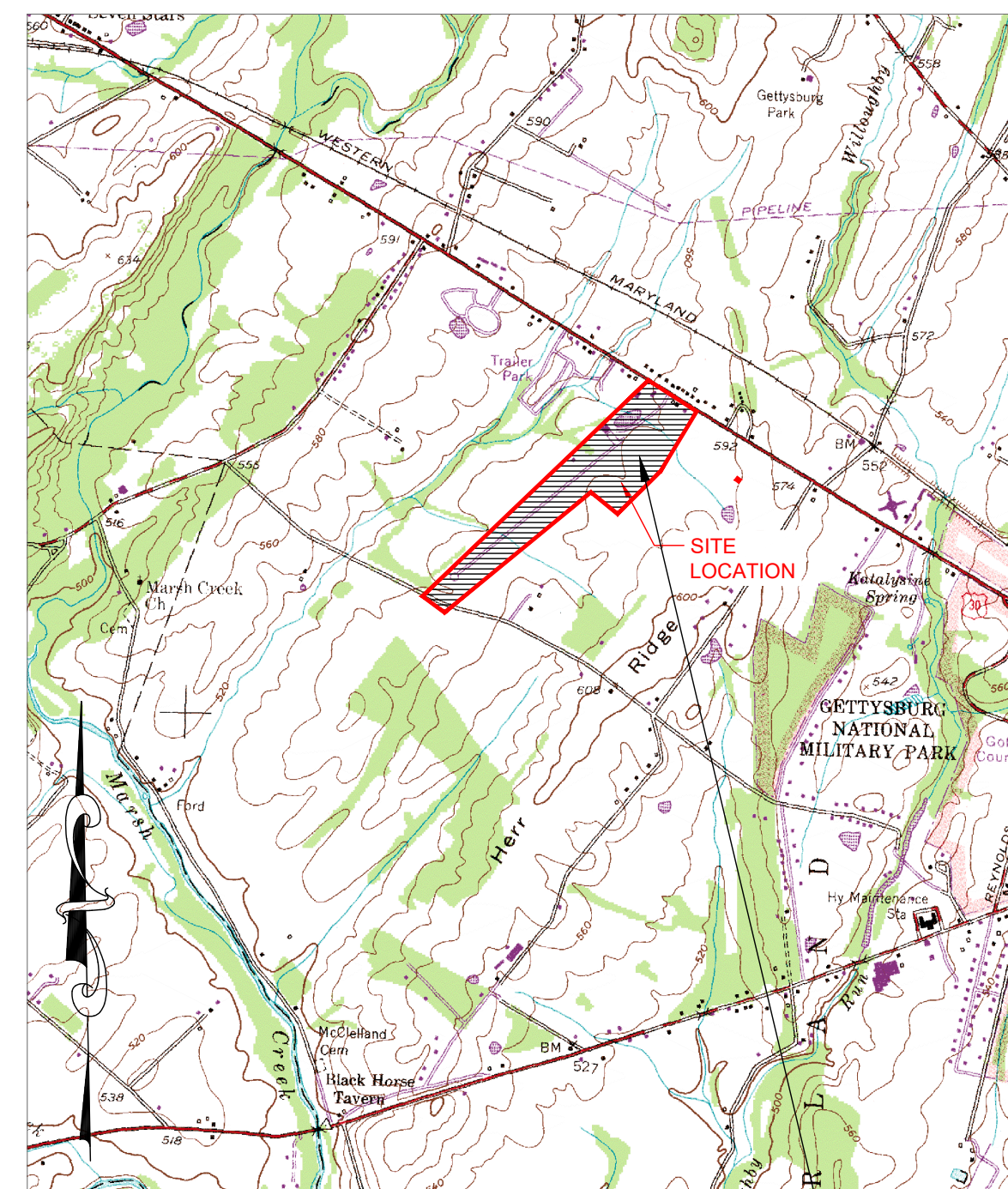

SITE LOCATION MAP
SCALE: 1" = 2000 FT

UNNAMED TRIBUTARY TO MARSH CREEK
DESIGNATED USE - CWF
EXISTING USE - CWF



SOILS MAP
SCALE: 1" = 400 FT

STOP - CALL US BEFORE YOU DIG
PENNSYLVANIA ONE CALL SYSTEMS, INC.
3 BUSINESS DAYS NOTICE IS THE LAW!
8-1-1 OR 1-800-242-1776
www.paonecall.org



Know what's below.
Call before you dig.

General Utility & One Call Information:

The location of existing underground utilities are shown in an approximate way only and have not been independently verified by the Using Agency. The Contractor shall determine the exact location of all existing utilities before commencing work, and agrees to be fully responsible for any and all damages which may occur by the Contractor's failure to exactly locate and preserve any and all utilities.

Contractor shall notify the PA One Call System not less than three (3) days prior to construction. The Contractor shall place the call and provide an approximate date and time that digging will occur. The One Call System will then notify the public and private utilities in the area. Public and private utilities will then coordinate directly with the Contractor for actual field locations.

PA One Call System Phone: 8-1-1 OR 1-800-242-1776
POCS Serial Number: 20192332138

DESIGNED	MAK	7/23
		DATE
DRAWN	MAK	7/23
		DATE
CHECKED	GLS	7/23
		DATE
APPROVED	GLS	7/23
		DATE

REVISIONS			
DATE	BY	DESCRIPTION	
2/24	MAK	ADDED HAUL ROAD, REMOVED ADD ALTERNATE	
4/8/24	TJN	ADDENDUM #1	

OWNER: SUSQUEHANNA AREA REGIONAL AIRPORT AUTHORITY
ONE TERMINAL DRIVE, SUITE 300
MIDDLETOWN, PA 17057
PHONE: 717.948.3900



GETTYSBURG REGIONAL AIRPORT (W05)

TIMOTHY J. EDWARDS
EXECUTIVE DIRECTOR
tedwards@saraa.org

LOUIS J. PIROZZI, PE
DEPUTY DIRECTOR OF ENGINEERING & PLANNING
louis.pirozzi@saraa.org

1130 CHAMBERSBURG ROAD
GETTYSBURG, PA 17325
ADAMS COUNTY
CUMBERLAND TOWNSHIP
PARCEL ID: 09E12-0107



CONSTRUCT SOUTH AIRCRAFT PARKING APRON, PHASE VI

E & S DETAILS - SHEET 1 OF 5

AP-17

PROJECT NO	P707220067	DATE	JULY 2023
------------	------------	------	-----------

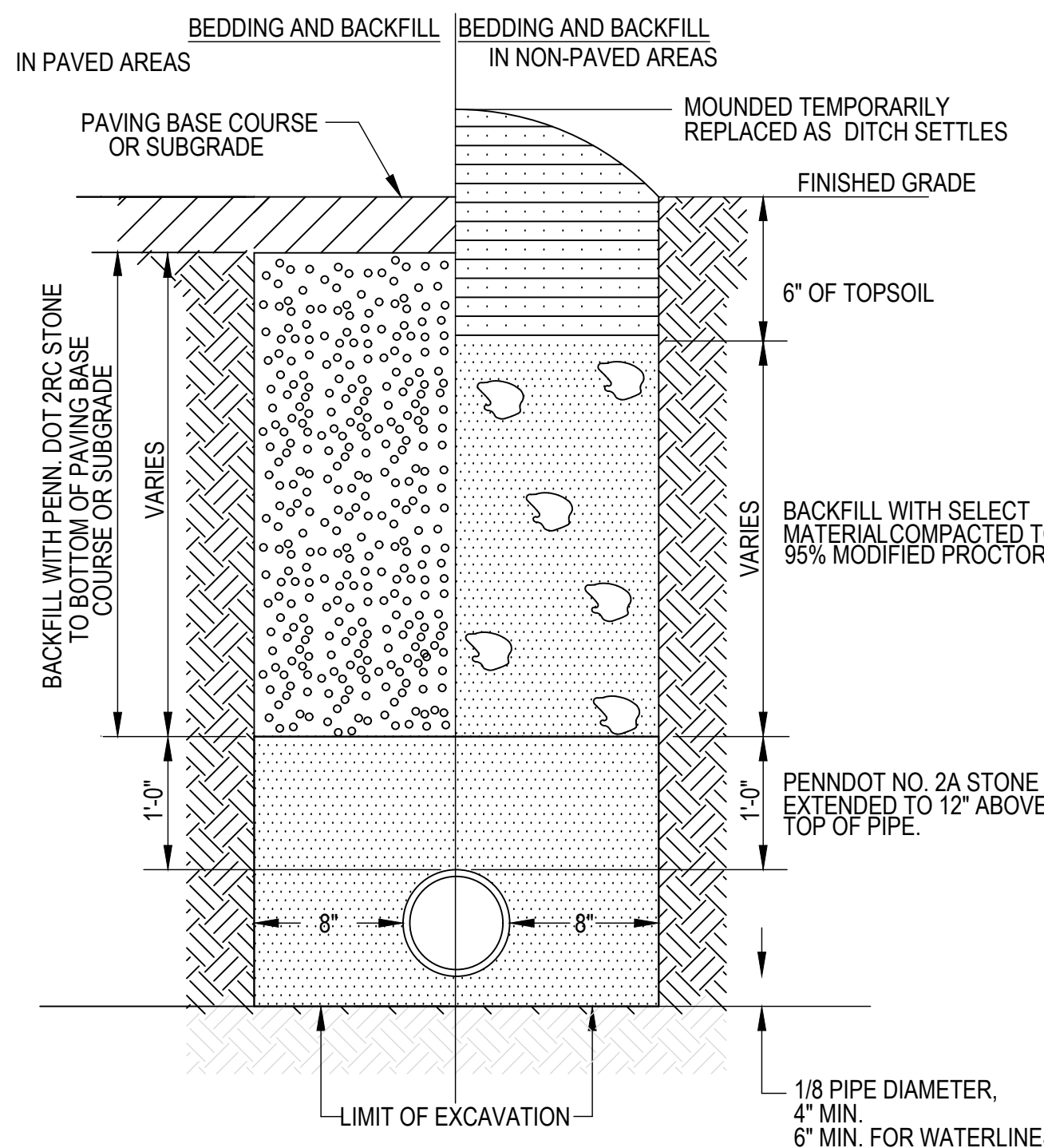

ISDP METHOD OF BACKFILL FOR PIPE TRENCHES
NOT TO SCALE

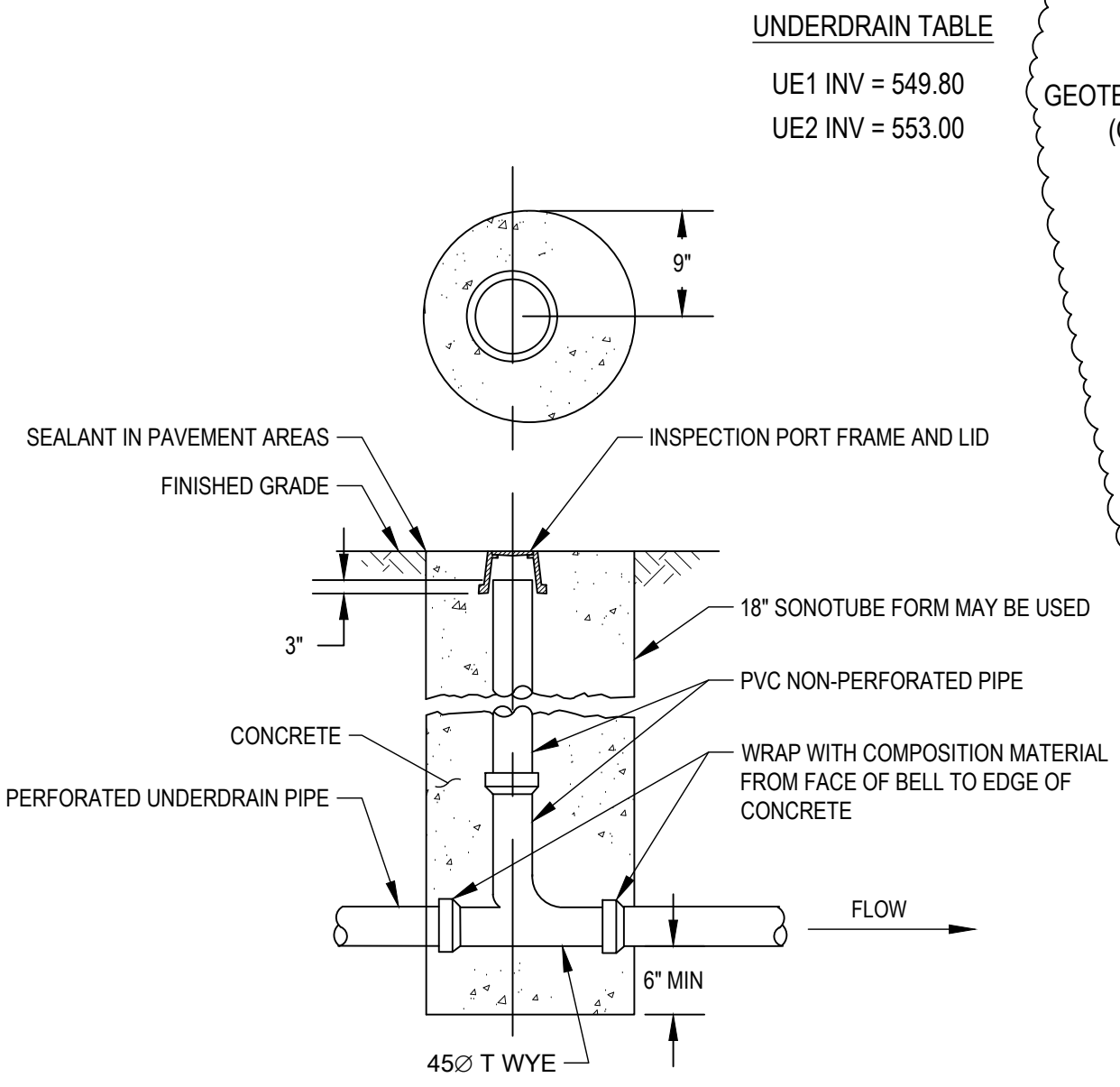

COT UNDERDRAIN CLEANOUT STRUCTURE
NOT TO SCALE

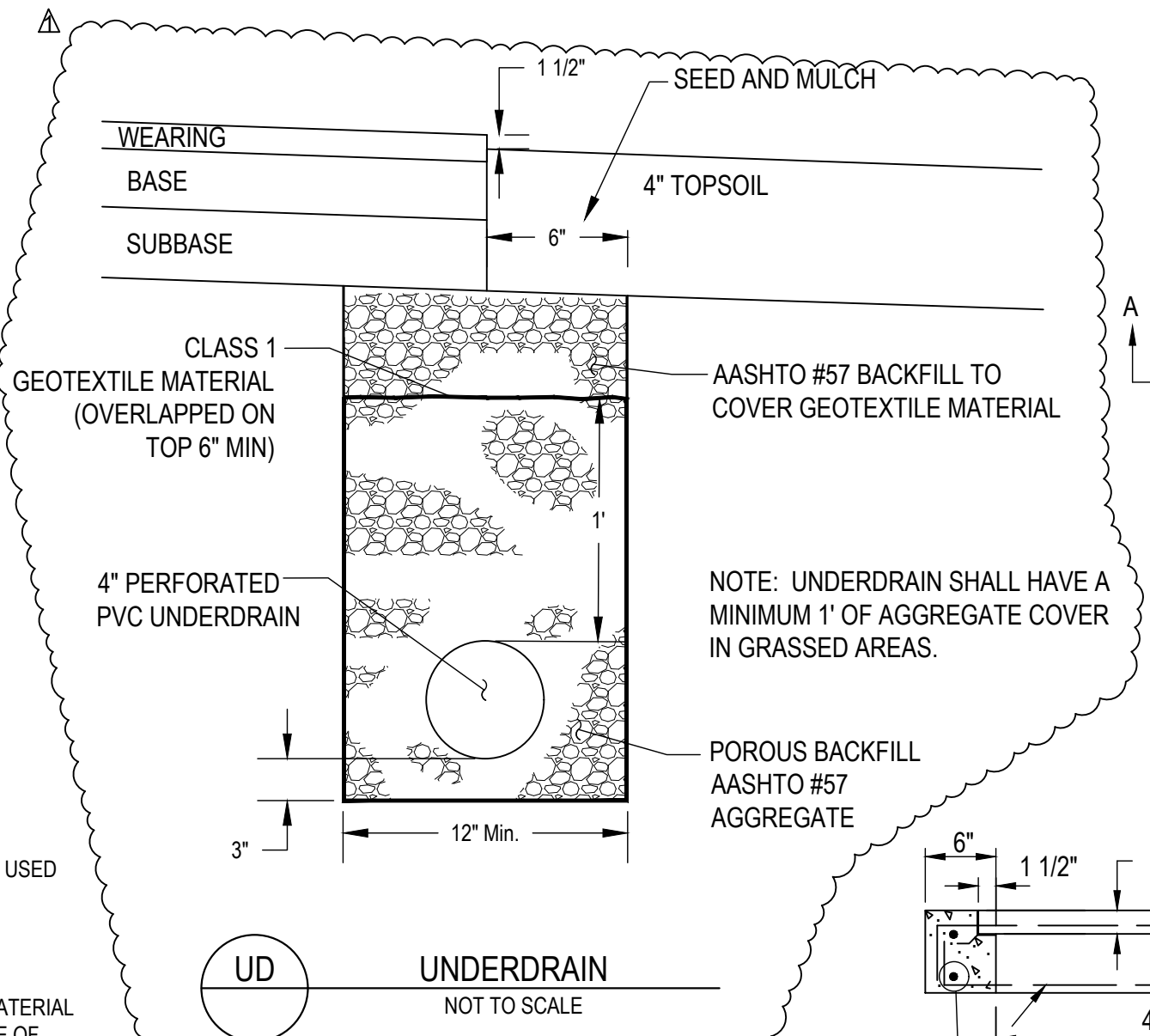

UD UNDERDRAIN
NOT TO SCALE

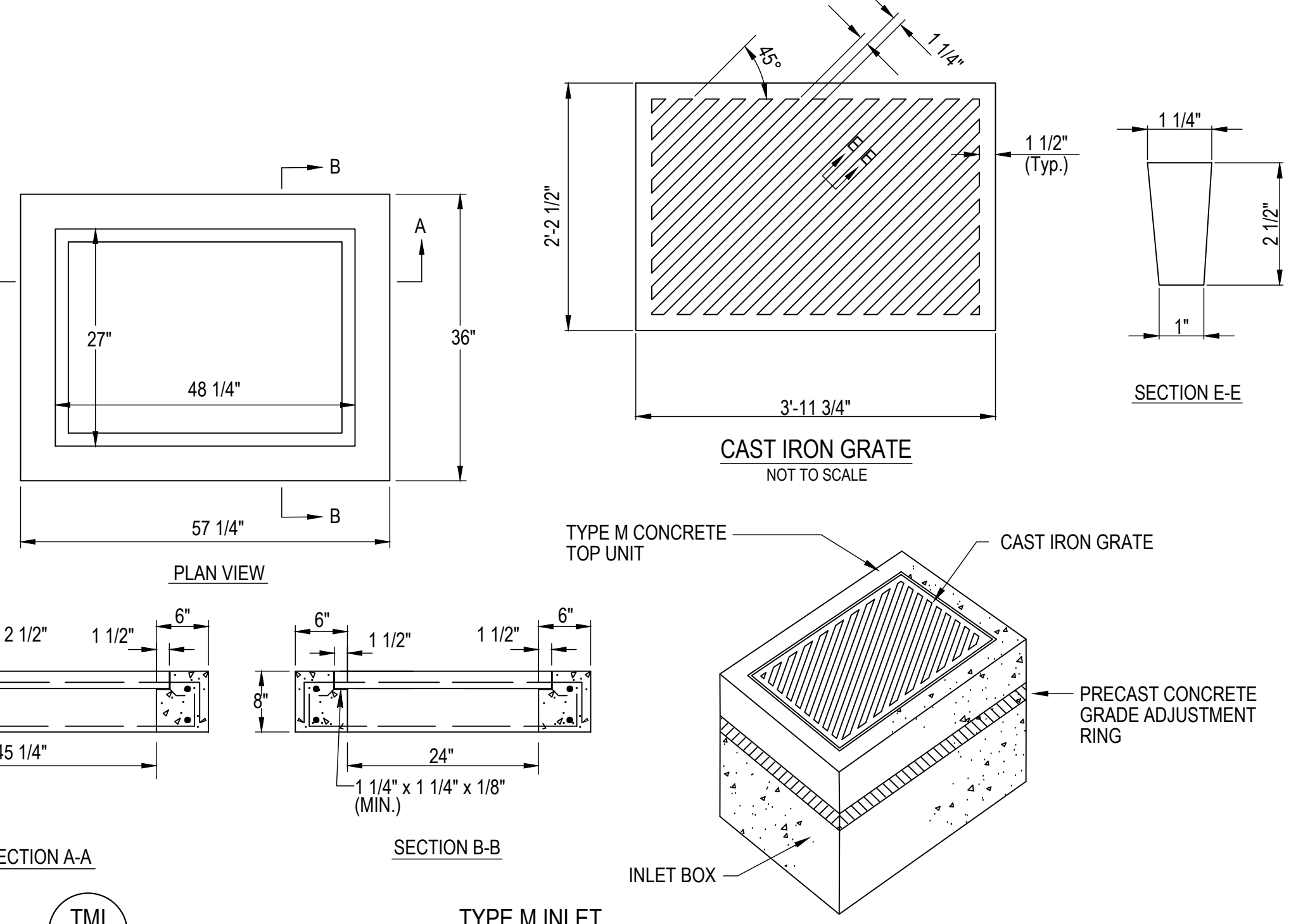

TMI TYPE M INLET
NOT TO SCALE

TYPE-DW ENDWALL NOTES:

1. PROVIDE MATERIALS AND WORKMANSHIP IN ACCORDANCE WITH THE REQUIREMENTS OF PENN DOT PUBLICATION 408 SPECIFICATIONS, SECTION 605 AND SECTION 714 AND PUBLICATION 72, SECTION RC31.
2. THIS STANDARD DEPICTS THE SHAPE AND DIMENSIONS REQUIRED FOR UNIFORMITY AND COMPATIBILITY. IT DOES NOT INCLUDE DETAILS REQUIRED FOR MANUFACTURING AND HANDLING PRECAST UNITS.
3. CHAMFER ALL EXPOSED EDGES 1".
4. PROVIDE PIPE OPENING SIZE IN PRECAST UNITS AT LEAST TWO (2) INCHES, BUT NOT MORE THAN FOUR (4) INCHES LARGER THAN THE OUTSIDE DIAMETER OF THE PIPE.
5. PROVIDE NON-SHRINK EPOXY GROUT THROUGHOUT THE CONTACT SURFACE WHEN CONNECTING WING AND HEADWALL SECTION TO THE BASE SECTION. PROVIDE JOINT SEALANT MATERIAL ALONG INTERFACE BETWEEN WING AND HEADWALL SECTION AND BASE SECTION.
6. PROVIDE A 1-INCH MORTAR BED PLACED ON TOP OF THE SUB-BASE MATERIAL FOR LEVELING PURPOSES, WHEN REQUIRED.
7. PROVIDE REINFORCEMENT MEETING THE REQUIREMENTS OF PENN DOT PUBLICATION 408, SECTION 709 AND PUBLICATION 72, SECTION RC31.
8. THE TOP ELEVATIONS SHOWN ARE BASED ON A MINIMUM WALL THICKNESS PER ASTM C-76, WALL "B".
9. SOME HEADWALLS HAVE MULTIPLE PIPES AND ELLIPTICAL PIPES.

TABLE A
2:1 OR 3:1 EMBANKMENT SLOPES

PIPE DIAMETER (IN.)	L (FT.)	W ₁ (FT.)	W ₂ (FT.)	A (IN.)
≤ 36	5.8	0	4.6	12
42	6.3	0	5.8	12

$$SD = \frac{d}{\cos \theta} = \frac{d}{\sin \text{SKEW}} \times$$

$$L = SD + 2.3'$$

$$W_1 = \frac{2d - 2'}{\cos \theta} \text{ (FOR 2:1 SLOPE)}$$

$$W_2 = \frac{X}{\cos \theta} \text{ (d-0.5-) } \frac{1.0}{X}$$

(FOR VARIABLE SLOPE WHEN X EQUALS HORIZONTAL DIMENSION OF THE SLOPE DESIGNATION.)

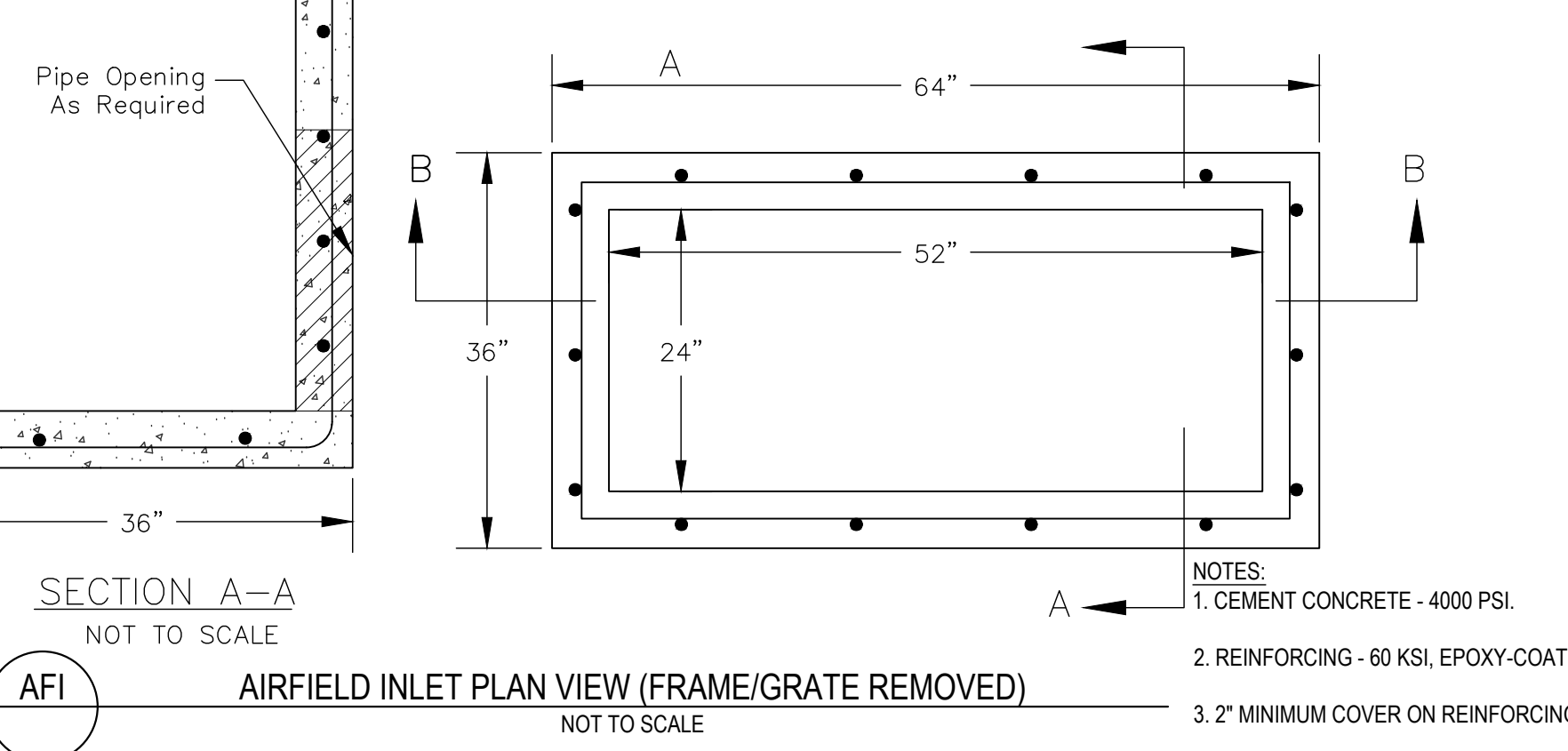
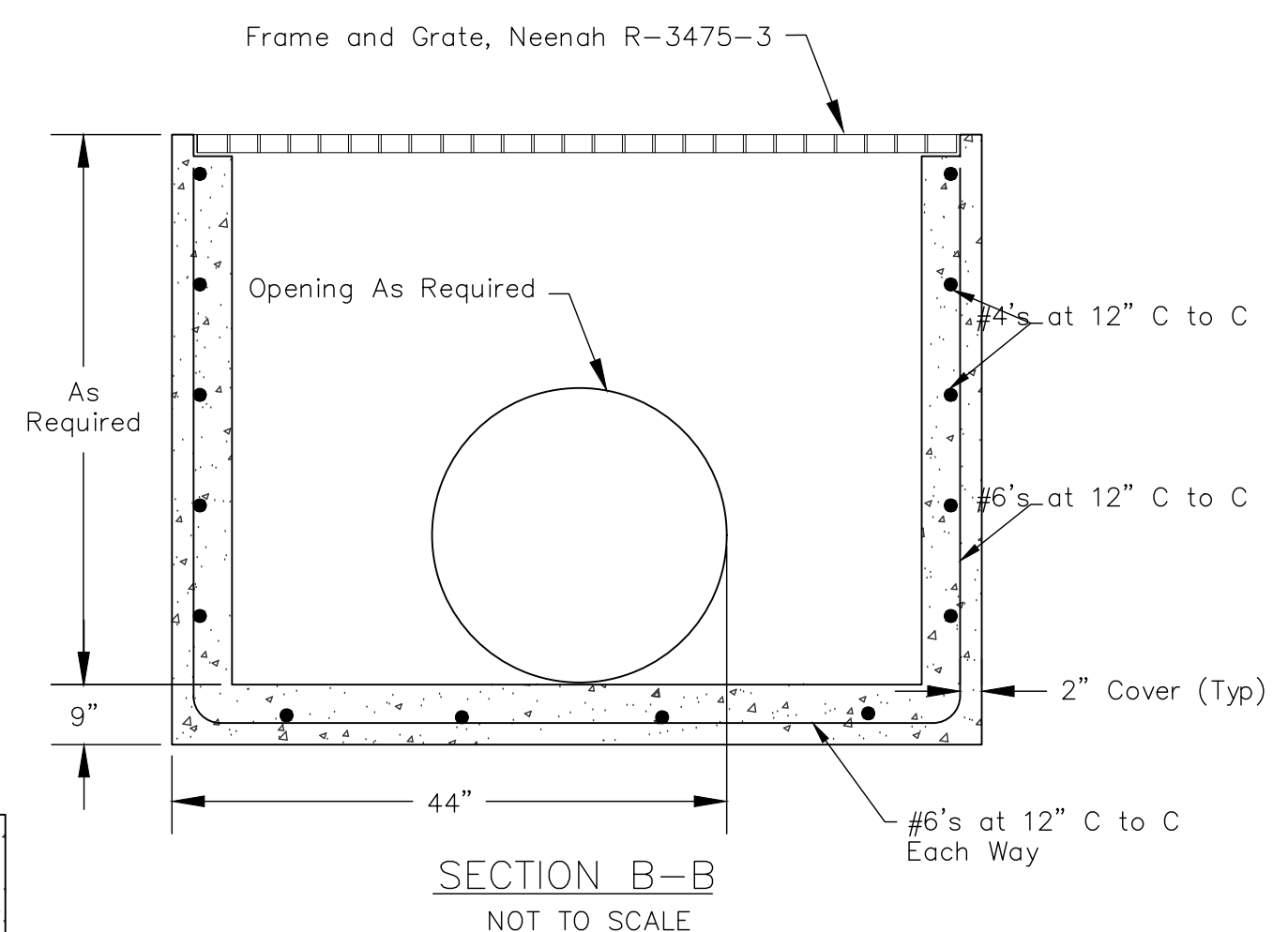

AFI AIRFIELD INLET PLAN VIEW (FRAME/GRATE REMOVED)
NOT TO SCALE

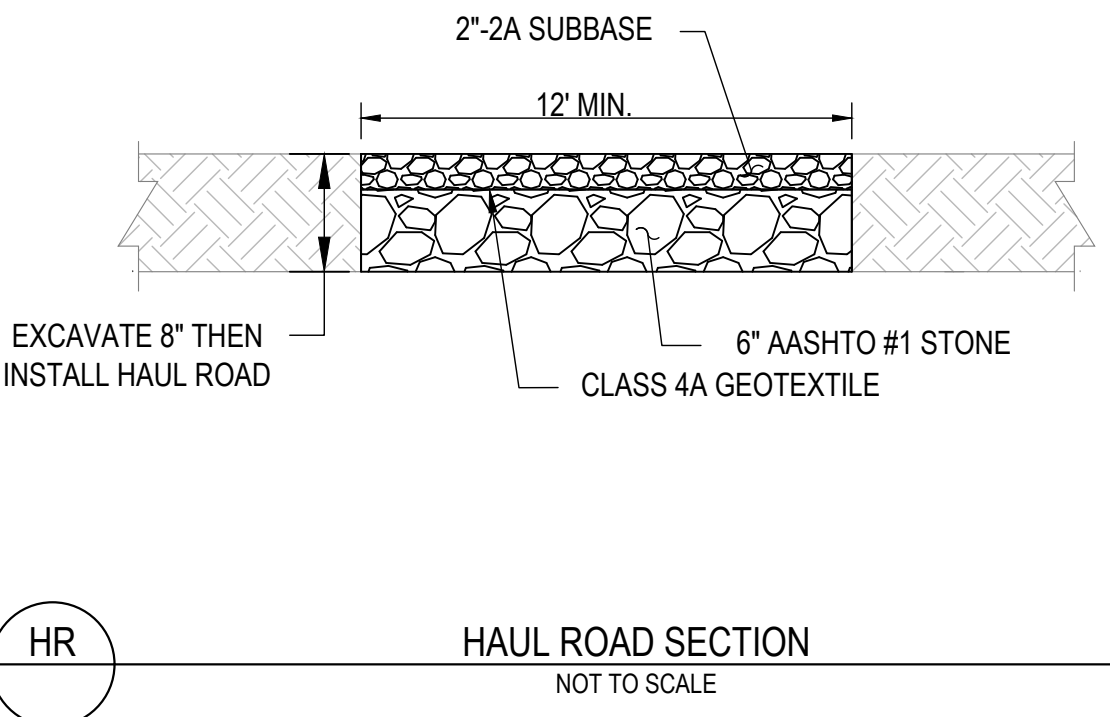

HR HAUL ROAD SECTION
NOT TO SCALE

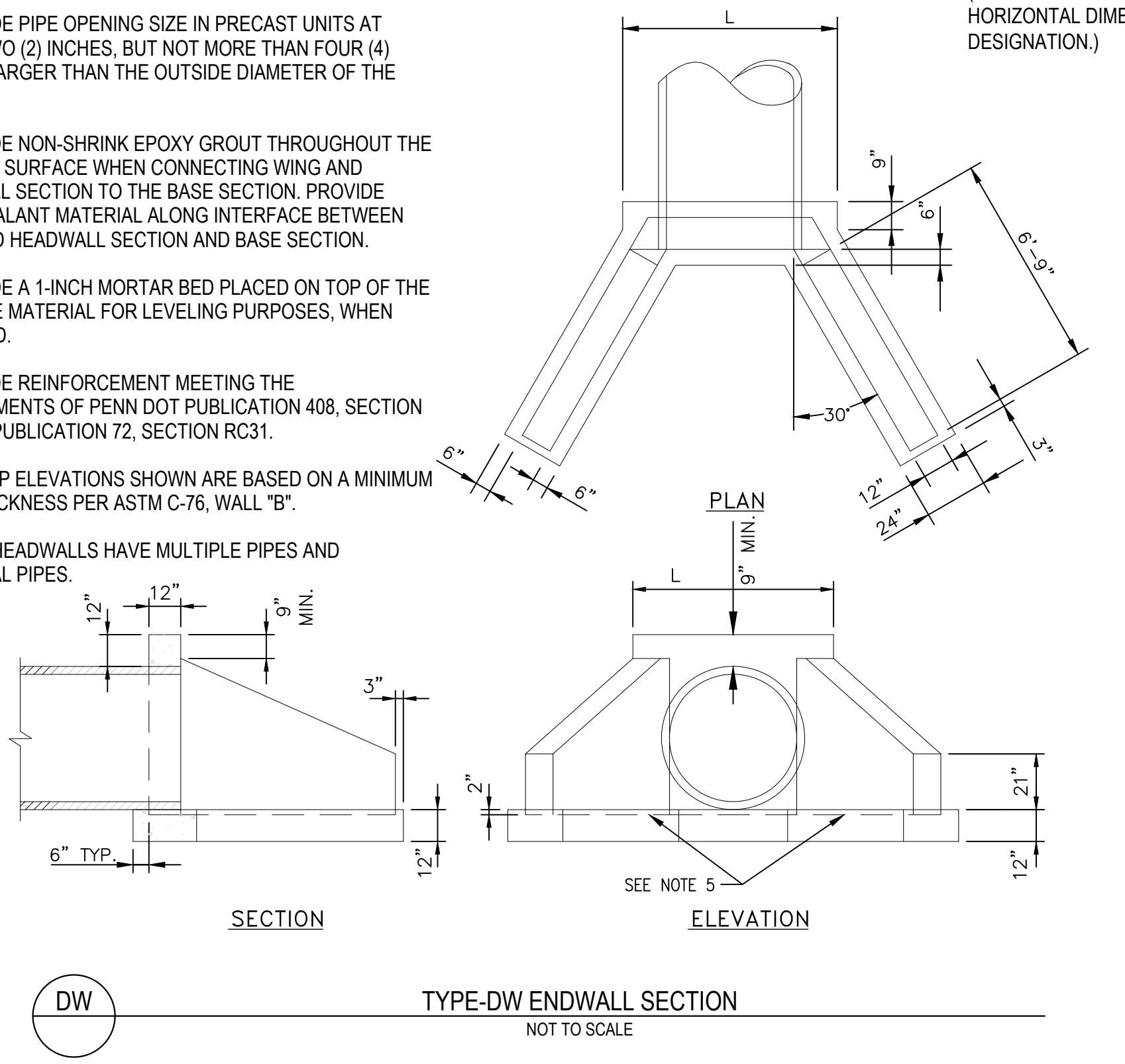

DW TYPE-DW ENDWALL SECTION
NOT TO SCALE

TranSystems
615 West Highland Avenue
Ebensburg, PA 15931
Phone: (814) 419-7883
Email: glschrock@transystems.com
Website: www.transystems.com

DESIGNED	MAK	7/23	DATE
DRAWN	MAK	7/23	DATE
CHECKED	GLS	7/23	DATE
APPROVED	GLS	7/23	DATE

DATE	BY	DESCRIPTION
2/24	MAK	ADDED HAUL ROAD, REMOVED ADD ALTERNATE
4/8/24	TJN	ADDENDUM #1

OWNER: SUSQUEHANNA AREA REGIONAL AIRPORT AUTHORITY
ONE TERMINAL DRIVE, SUITE 300
MIDDLETOWN, PA 17057
PHONE: 717.948.3900

GETTYSBURG REGIONAL AIRPORT (W05)

TIMOTHY J. EDWARDS
EXECUTIVE DIRECTOR
tedwards@saraa.org

LOUIS J. PIROZZI, PE
DEPUTY DIRECTOR OF ENGINEERING & PLANNING
louis.pirozzi@saraa.org

1130 CHAMBERSBURG ROAD
GETTYSBURG, PA 17325
ADAMS COUNTY
CUMBERLAND TOWNSHIP
PARCEL ID: 09E12-0107

GRA
Gettysburg Regional Airport

CONSTRUCT SOUTH AIRCRAFT PARKING APRON, PHASE VI

DRAINAGE AND PAVING DETAILS

PROJECT NO: P707220067
DATE: JULY 2023

AP-22